

**RICAMBI PER
MACINACAFFE'**

MACINADOSATORE

ROSSI RR 45 AUTOMATICO

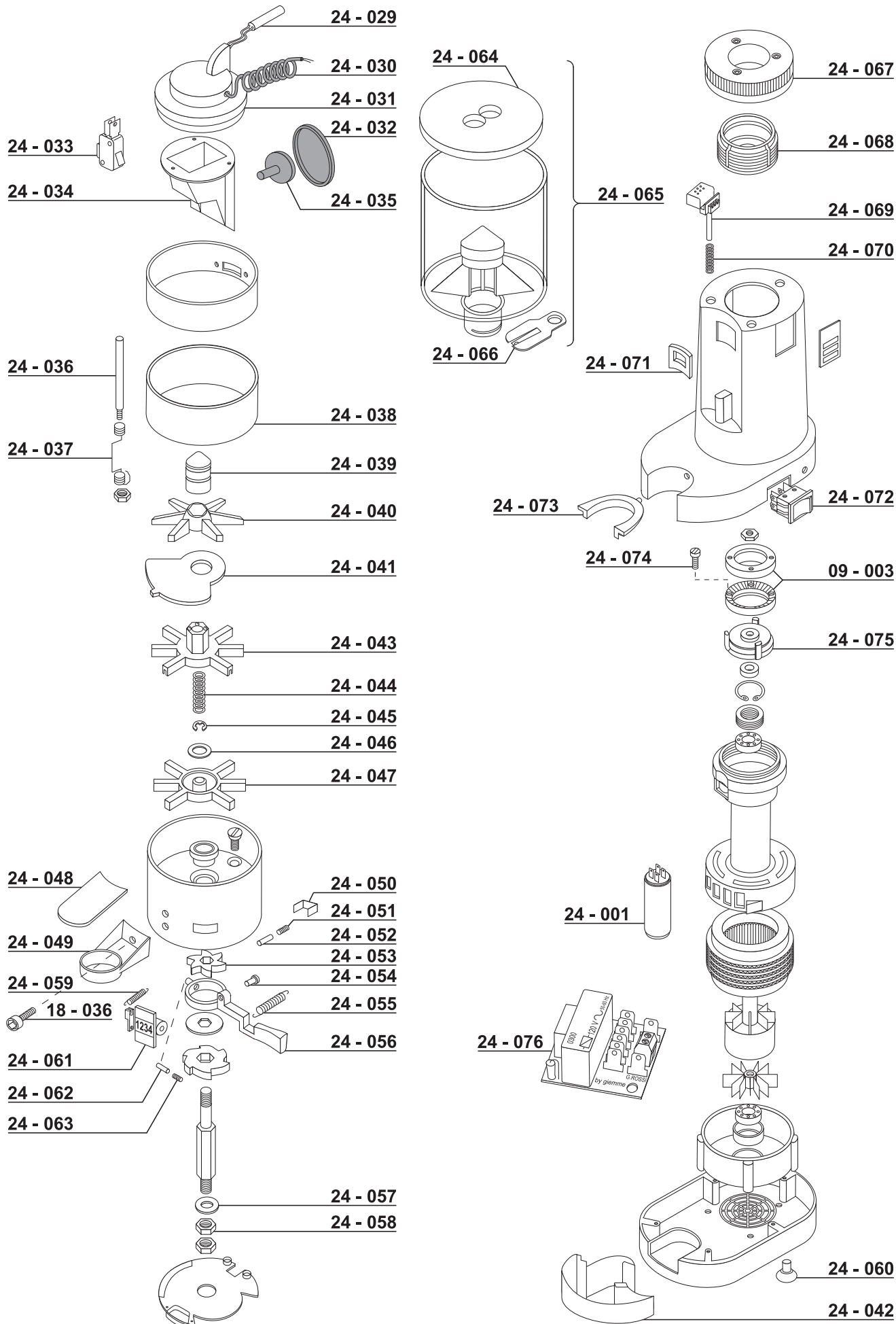

MACINADOSATORE MAZZER SUPER JOLLY

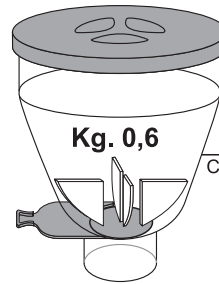

24 - 139
CAMPANA COMPLETA
MAZZER MINI

24 - 120

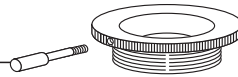

24 - 121



09 - 011

COPPIA DI MACINE



24 - 122



24 - 123



24 - 124



24 - 137 MANUALE
24 - 138 AUTOMATICO

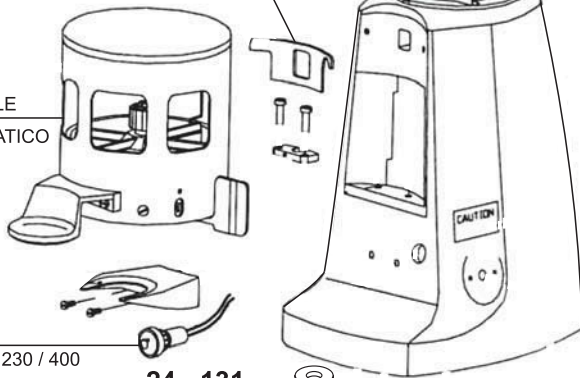

24 - 125
SPIA VERDE V.230 / 400

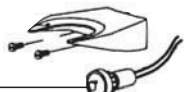

24 - 131



24 - 126
PIATTINO INOX



24 - 136



24 - 133

24 - 134 + START

TIMER BIPOLARE **24 - 129**
TIMER TRIPOLARE **24 - 135**



24 - 130

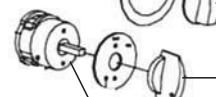

24 - 132

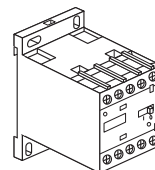

24 - 028
A9 V. 220 AC

24 - 010 10 μ F
24 - 102 8 μ F



MACINADOSATORE MAZZER SUPER JOLLY

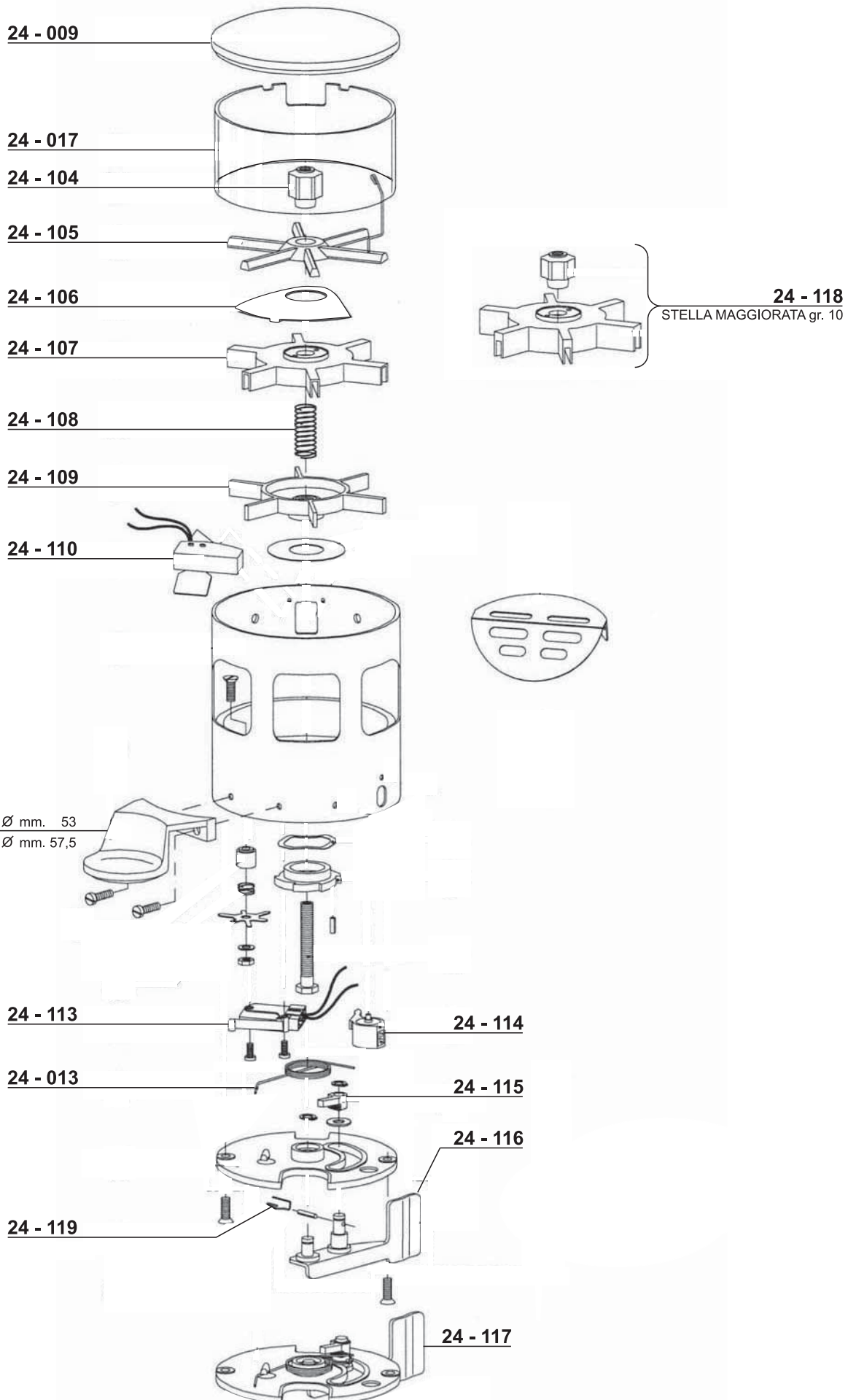

MACINADOSATORE

MACAP MXK 350 AUTOMATICO

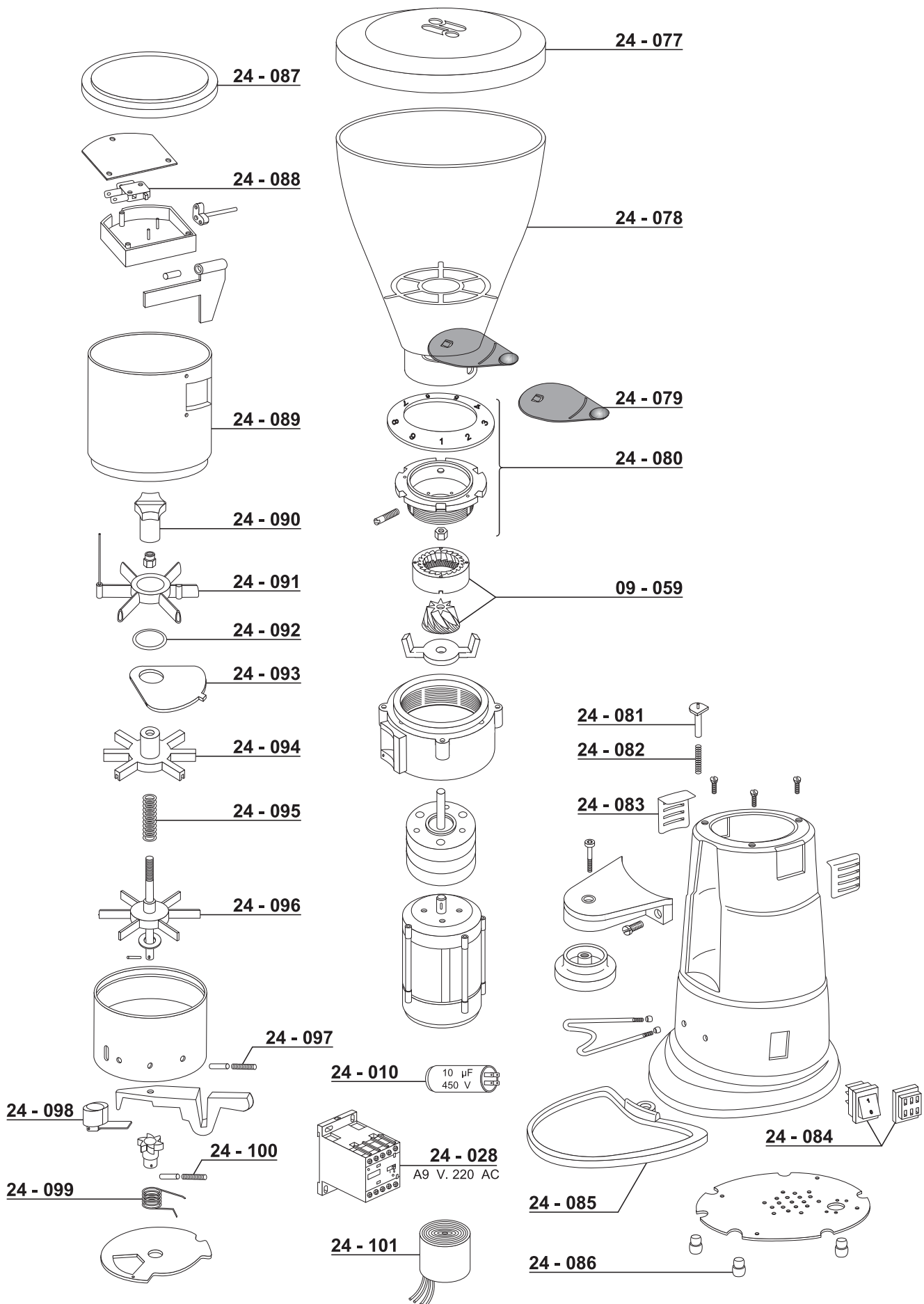

RICAMBI PER MACINACAFFE'

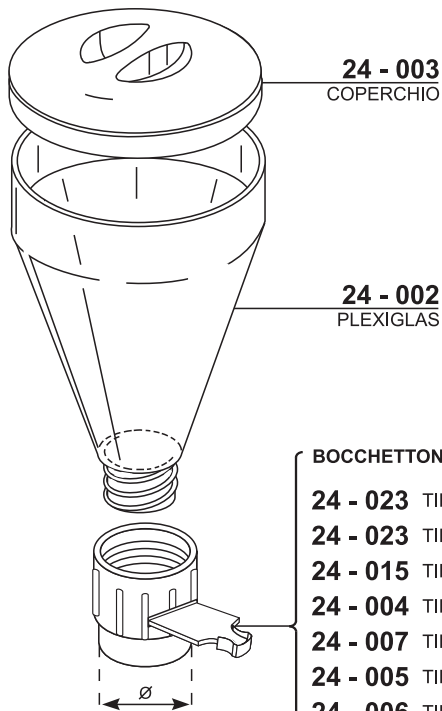

CAMPANE COMPLETE

24 - 024	TIPO ASTORIA	Ø 52
24 - 024	TIPO BRASILIA	Ø 52
12 - 193	TIPO CIMBALI	Ø 54
11 - 314	TIPO FAEMA	Ø 55
24 - 026	TIPO FIORENZATO	Ø 68
13 - 113	TIPO GAGGIA	Ø 66
24 - 016	TIPO MAZZER	Ø 57
24 - 024	TIPO ROSSI	Ø 52
24 - 025	TIPO S.MARCO	Ø 68

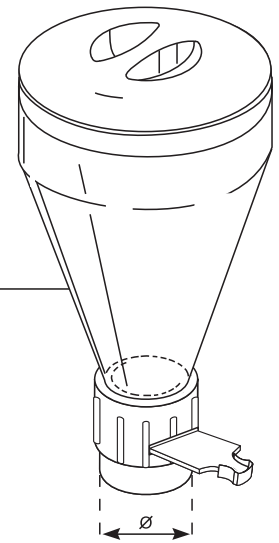

BOCCHETTONI

24 - 023	TIPO ASTORIA	Ø 52
24 - 023	TIPO BRASILIA	Ø 52
24 - 015	TIPO CIMBALI	Ø 54
24 - 004	TIPO FAEMA	Ø 55
24 - 007	TIPO FIORENZATO	Ø 68
24 - 005	TIPO GAGGIA	Ø 66
24 - 006	TIPO MAZZER	Ø 57
24 - 023	TIPO ROSSI	Ø 52
24 - 007	TIPO S.MARCO	Ø 68

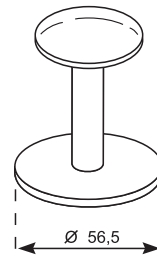

11 - 214
PLASTICA

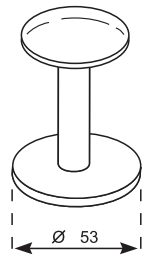

14 - 222
PLASTICA

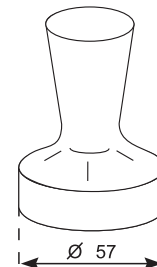
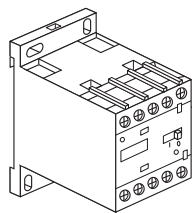
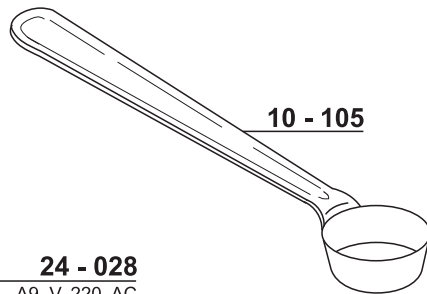

11 - 300
INOX

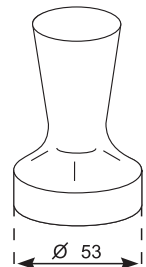

14 - 217
INOX

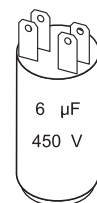
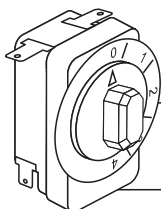

24 - 027

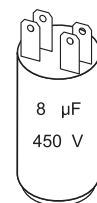

24 - 102

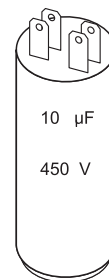

24 - 010

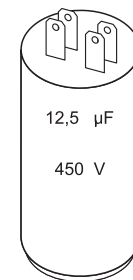

24 - 001

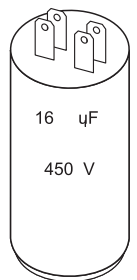

24 - 103

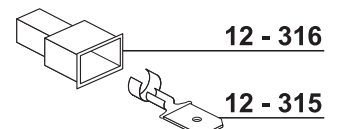
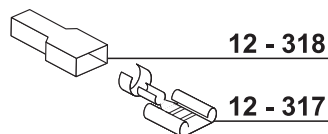
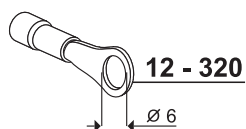
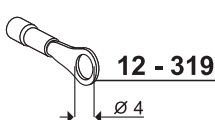



MACINE GRINDERS

CODICE CODES	DESCRIZIONE DESCRIPTION	Ø mm. ESTERNO - INTERNO EXTERNAL-INTERNAL Ø mm.		SPESSORE THICKNESS	FORI HOLES	ROTAZIONE ROTATION
09-028	ANFIM 900 GIRI	75	42	10,5	3	SX-LEFT
09-001	ANFIM	54	32	7	3	SX-LEFT
09-002	ANFIM	64	37	9	3	SX-LEFT
09-030	ARISTARCO	84	46	9	3	DX-RIGHT
09-034	ARISTARCO	58	35	8	3	DX-RIGHT
09-043	ARISTARCO	64	37	8,5	3	DX-RIGHT
09-011	ASTORIA - MAZZER	64	37	8,5	3	DX-RIGHT
09-003	ASTORIA - ROSSI	63,5	37	9	3	SX-LEFT
09-003	AURORA	63,5	37	9	3	SX-LEFT
09-003	BRASILIA	63,5	37	9	3	SX-LEFT
09-042	BRASILIA CONICA	68	41	25	4	DX-RIGHT
09-006	CASADIO	64	34,5	10,5	2	DX-RIGHT
09-054	CASADIO	84	45	10,5	3	SX-LEFT
09-042	CASADIO CONICA Mod. GC 98	68	41	25	4	DX-RIGHT
09-008	CIMBALI	54	32	9	3	DX-RIGHT
09-009	CIMBALI	64	37	9	3	DX-RIGHT
09-010	CIMBALI VECCHIO TIPO ROTAZ. SINISTRA	64	37	9	3	SX-LEFT
09-011	CIMBALI - ALINOX	64	37	8,5	3	DX-RIGHT
09-039	CIMBALI - ALINOX	68	43	7,5	3	DX-RIGHT
09-046	CIMBALI MAGNUM	75	43	9	3	DX-RIGHT
09-016	CIMBALI CONIK	68	41	25	4	DX-RIGHT
09-058	CUNILL	59	30/35	9		SX-LEFT
09-011	D.R.M.	64	37	8,5	3	DX-RIGHT
09-039	D.R.M.	68	43	7,5	3	DX-RIGHT
09-035	EROS CONICA	68	41	25	4	DX-RIGHT
09-014	EUREKA - CONTI	64	37	9	3	DX-RIGHT
09-015	EUREKA - CONTI	64	37	9	3	SX-LEFT
09-045	EUREKA - CONTI CONICA	68	41	25	4	DX-RIGHT
09-016	FAEMA CONICA	68	41	25	4	DX-RIGHT
09-017	FAEMA MP - MPN	54	31	8	3	DX-RIGHT
09-012	FAEMA FM	54	31	8	3	SX-LEFT
09-041	FAEMA A 6 - S 6	64,1	38	9	3	DX-RIGHT
09-046	FAEMA M D 2000	75	43	9	3	DX-RIGHT
09-013	FAEMA	62	37,5	9	3	SX-LEFT
09-013	FAEMA - FUTURMAT	62	37,5	9	3	SX-LEFT
09-029	FIORENZATO	63	38	8,5	3	DX-RIGHT
09-018	FIORENZATO	83	45	9,5	3	DX-RIGHT
09-032	GAGGIA BABY	50	30	7,5	3	DX-RIGHT
09-011	GAGGIA (ARISTARCO)	64	37	8,5	3	DX-RIGHT
09-030	GAGGIA (ARISTARCO)	84	46	9	3	DX-RIGHT
09-034	GAGGIA (ARISTARCO)	58	35	8	3	DX-RIGHT
09-031	GAGGIA MILANO	85	45	9	3	DX-RIGHT
09-005	LA SCALA M4 M5 MONOFASE	58	34	8,5	3	DX-RIGHT
09-020	LA SCALA MX MONOFASE	65	38	8	3	DX-RIGHT
09-024	LA SCALA M7 MONOFASE	74	42	9	3	DX-RIGHT



MACINE GRINDERS

CODICE CODES	DESCRIZIONE DESCRIPTION	Ø mm. ESTERNO - INTERNO EXTERNAL-INTERNAL Ø mm.		SPESSORE THICKNESS	FORI HOLES	ROTAZIONE ROTATION
09-042	LA SCALA M7K CONICHE	68	41	25	4	DX-RIGHT
09-059	LA SCALA MXK CONICHE	63	40	23	3	DX-RIGHT
09-005	MACAP M4 M5 MONOFASE	58	34	8,5	3	DX-RIGHT
09-020	MACAP MX MONOFASE	65	38	8	3	DX-RIGHT
09-024	MACAP M7 MONOFASE	74	42	9	3	DX-RIGHT
09-042	MACAP M7K CONICHE	68	41	25	4	DX-RIGHT
09-059	MACAP MXK CONICHE	63	40	23	3	DX-RIGHT
09-020	MACAP	65	38	8	3	DX-RIGHT
09-059	MACAP CONICA	63	40	23	3	DX-RIGHT
09-020	MACDOBAR MONOFASE	65	38	8	3	DX-RIGHT
09-056	MAZZER MINI	58	33	8,5	3	DX-RIGHT
09-011	MAZZER - SUPER JOLLY	64	37	8,5	3	DX-RIGHT
09-021	MAZZER S.JOLLY MONOF. LUNGA DURATA	64	37	8,5	3	DX-RIGHT
09-033	MAZZER MAJOR - STAR - ROYAL	83	49,5	9	3	DX-RIGHT
09-004	MAZZER KONY CONICA MONOFASE	63	12	23	3	DX-RIGHT
09-047	MAZZER ROBUR CONICA MONOFASE	71	14	25	3	DX-RIGHT
09-048	MAZZER ROBUR CONICA TRIFASE	83	14	25	3	DX-RIGHT
09-003	NUOVA SIMONELLI MDS-A	63,5	37	9	3	SX-LEFT
09-014	NUOVA SIMONELLI MDX-A	64	37	9	3	DX-RIGHT
09-045	NUOVA SIMONELLI MDL-C CONICA	68	41	25	4	DX-RIGHT
09-003	OBEL	63,5	37	9	3	SX-LEFT
09-006	OMUS	64	34,5	10,5	2	DX-RIGHT
09-022	QUICK MILL	54	30	8	3	DX-RIGHT
09-023	QUICK MILL	66	35	9	3	SX-LEFT
09-057	RANCILIO ROCKY - JACKY MD 40	50	31	8	3	SX-LEFT
09-003	RANCILIO	63,5	37	9	3	SX-LEFT
09-028	RANCILIO	75	42	10,5	3	SX-LEFT
09-003	ROSSI	63,5	37	9	3	SX-LEFT
09-042	ROSSI CONICA	68	41	25	4	DX-RIGHT
09-040	SAECO	43	25	6,5	3	SX-LEFT
09-043	S.MARCO	64	37	8,5	3	DX-RIGHT
09-042	S.MARCO CONICA 1° TIPO <u>VITI LUNGHE</u>	68	41	25	4	DX-RIGHT
09-053	S.MARCO CONICA ULTIMO TIPO <u>VITI CORTE</u>	68	41	25	4	DX-RIGHT
09-030	S.MARCO AUTOMATICO	84	46	9	3	DX-RIGHT
09-052	S.MARCO SEMICONICA	84	45,5	9	4	DX-RIGHT
09-028	SPAZIALE 900 GIRI	75	42	10,5	3	SX-LEFT
09-027	VITTORIA	84,5	45	9	4	DX-RIGHT
09-056	WEGA COMPAK MINI	58	33	8,5	3	DX-RIGHT
09-055	WEGA COMPAK K-5	60	36	8	3	DX-RIGHT
09-049	WEGA COMPAK K-6	63,5	38	9	3	DX-RIGHT
09-051	WEGA COMPAK K-7	75	41	10	3	DX-RIGHT
09-050	WEGA COMPAK K-8	80	41	10	3	DX-RIGHT