



Client _____ Quantity _____
 Project _____ Position _____

ROC 700

Electric range, 4 square plates, on cabinet with doors

Model: R70/80PCEQ/P

Cod: MP01014123055

Technical data

Modularity:	On cabinet with doors
Dimension (mm):	800x730x870 mm
Total electric power (kW):	10,4
Electric power (V):	380-415
Ampere (A):	24
Phases:	3N
Cable section (mmq):	5G4
Frequency (Hz):	50-60
Net volume (m3):	0,508
Packing dimensions (mm):	880x856x1109 mm
Gross weight (Kg):	77,6
Gross volume (m3):	0,835

Features

Working top:	Made of AISI 304 stainless steel with a thickness of 20/10 mm
Knobs:	Made of aluminum with IPX5 water protection
Handles:	The brushed aluminum handles allow for a secure and sturdy grip with a ergonomic lines
Flue:	Removable gas exhaust flue grill made of cast iron

Technical draw

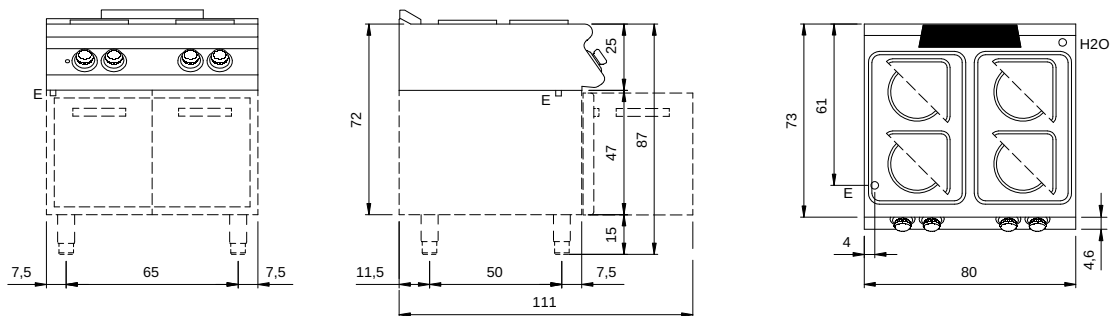

E: Electric power