

Client _____ Quantity _____
 Project _____ Position _____



ROC 700

Gas range pressed worktop, 2 burners, on open cabinet

Model: R70/40PCG/A

Cod: MP01014113001

Technical data

Modularity:	On open cabinet
Dimension (mm):	400x730x870
Total gas power (Kcal/h):	8169
Total gas power (kW):	9,5
Gas connection:	1/2"
Net volume (m3):	0,254
Packing dimensions (mm):	480x856x1075
Gross weight (Kg):	64
Burner power 1 (kW):	3,5
Burner power 2 (kW):	6
Gross volume (m3):	0,442

Features

Burners:	Single and double crown cast iron burners with brass burner cap
Grill:	For single burner in cast iron or stainless steel (optional) dishwasher safe
Working top:	Pressed top made of AISI 304 stainless steel 20/10 mm thick
Knobs:	Made of aluminum with IPX5 water protection
Flue:	Removable gas exhaust flue grill made of cast iron
Kit Gas:	natural gas conversion kit 30/50 m/bar (tested with natural gas G20)

In order to constantly offer the best possible products we reserve the right to make changes on technical specifications without incurring any obligation for equipment previously or subsequently sold.

Technical draw

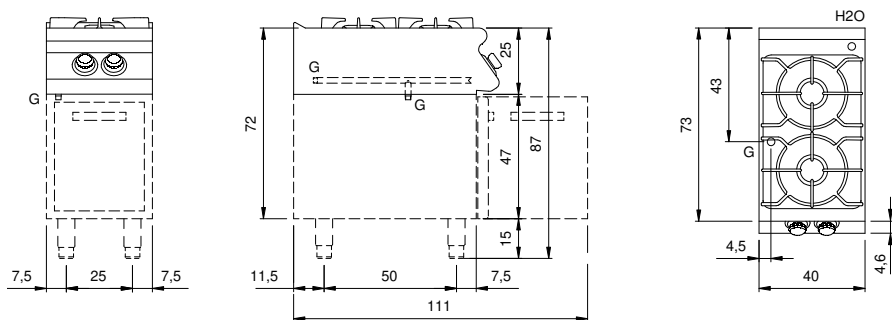

G: Gas connection 1/2"