

Client \_\_\_\_\_ Quantity \_\_\_\_\_  
 Project \_\_\_\_\_ Position \_\_\_\_\_



## ROC 700

Gas range pressed worktop, 2 burners, on cabinet with door

**Model:** R70/40PCG/P

**Cod:** MP01014113002

### Technical data

|                                  |                      |
|----------------------------------|----------------------|
| <b>Modularity:</b>               | On cabinet with door |
| <b>Dimension (mm):</b>           | 400x730x870          |
| <b>Total gas power (Kcal/h):</b> | 8169                 |
| <b>Total gas power (kW):</b>     | 9,5                  |
| <b>Gas connection:</b>           | 1/2"                 |
| <b>Net volume (m3):</b>          | 0,254                |
| <b>Packing dimensions (mm):</b>  | 480x856x1075         |
| <b>Gross weight (Kg):</b>        | 67                   |
| <b>Burner power 1 (kW):</b>      | 3,5                  |
| <b>Burner power 2 (kW):</b>      | 6                    |
| <b>Gross volume (m3):</b>        | 0,442                |

### Features

|                     |  |
|---------------------|--|
| <b>Burners:</b>     | Single and double crown cast iron burners with brass burner cap                        |
| <b>Grill:</b>       | For single burner in cast iron or stainless steel (optional) dishwasher safe           |
| <b>Working top:</b> | Pressed top made of AISI 304 stainless steel 20/10 mm thick                            |
| <b>Knobs:</b>       | Made of aluminum with IPX5 water protection  |
| <b>Handles:</b>     | The brushed aluminum handles allow for a secure and sturdy grip with a ergonomic lines |
| <b>Flue:</b>        | Removable gas exhaust flue grill made of cast iron                                     |
| <b>Kit Gas:</b>     | natural gas conversion kit 30/50 m/bar (tested with natural gas G20)                   |

**Technical draw**

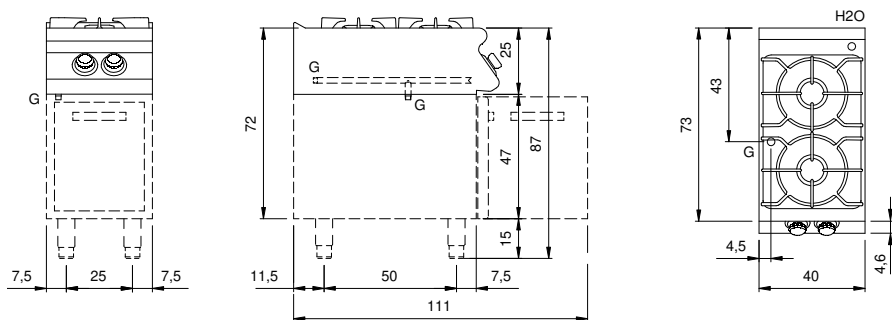

**G:** Gas connection 1/2"