

Client _____ Quantity _____
Project _____ Position _____



ROC 700

Gas range pressed worktop, 6 burners, on cabinet with doors

Model: R70/120PCG/P

Cod: MP01014113008

Technical data

Modularity:	On cabinet with doors
Dimension (mm):	1200x730x870
Total gas power (Kcal/h):	28805
Total gas power (kW):	33,5
Gas connection:	1/2"
Net volume (m3):	0,762
Packing dimensions (mm):	1280x856x1109
Gross weight (Kg):	126,1
Burner power 1 (kW):	3,5
Burner power 2 (kW):	6
Burner power 3 (kW):	6
Burner power 4 (kW):	6
Gross volume (m3):	1,215

Features

Burners:	Single and double crown cast iron burners with brass burner cap
Grill:	For single burner in cast iron or stainless steel (optional) dishwasher safe
Working top:	Pressed top made of AISI 304 stainless steel 20/10 mm thick
Knobs:	Made of aluminum with IPX5 water protection
Handles:	The brushed aluminum handles allow for a secure and sturdy grip with a ergonomic lines
Flue:	Removable gas exhaust flue grill made of cast iron
Kit Gas:	natural gas conversion kit 30/50 m/bar (tested with natural gas G20)

Technical draw

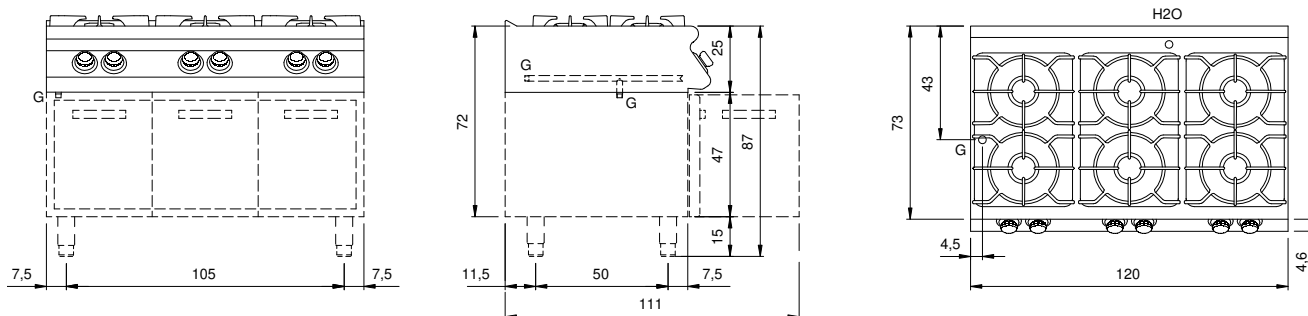

G: Gas connection 1/2"