

Client \_\_\_\_\_ Quantity \_\_\_\_\_  
 Project \_\_\_\_\_ Position \_\_\_\_\_



## ROC 700

Gas range pressed worktop, 4 burners, gas oven

**Model:** R70/80CFG

**Cod:** MP01034113000

### Technical data

<b>Modularity:</b>	Gas oven
<b>Dimension (mm):</b>	800x730x870
<b>Dimensione forno (mm):</b>	555x660x289
<b>Total gas power (Kcal/h):</b>	25366
<b>Total gas power (kW):</b>	29,5
<b>Oven type:</b>	Static oven
<b>Oven power (kW):</b>	8
<b>Oven temperature range (°C):</b>	95-300
<b>Gas connection:</b>	1/2"
<b>Net volume (m3):</b>	0,508
<b>Packing dimensions (mm):</b>	880x856x1109
<b>Gross weight (Kg):</b>	128,6
<b>Burner power 1 (kW):</b>	3,5
<b>Burner power 2 (kW):</b>	6
<b>Burner power 3 (kW):</b>	6
<b>Burner power 4 (kW):</b>	6
<b>Gross volume (m3):</b>	0,835

### Features

<b>Burners:</b>	Single and double crown cast iron burners with brass burner cap
<b>Grill:</b>	For single burner in cast iron or stainless steel (optional) dishwasher safe
<b>Working top:</b>	Pressed top made of AISI 304 stainless steel 20/10 mm thick
<b>Knobs:</b>	Made of aluminum with IPX5 water protection
<b>Handles:</b>	The brushed aluminum handles allow for a secure and sturdy grip with a ergonomic lines
<b>Flue:</b>	Removable gas exhaust flue grill made of cast iron
<b>Kit Gas:</b>	natural gas conversion kit 30/50 m/bar (tested with natural gas G20)

**Technical draw**

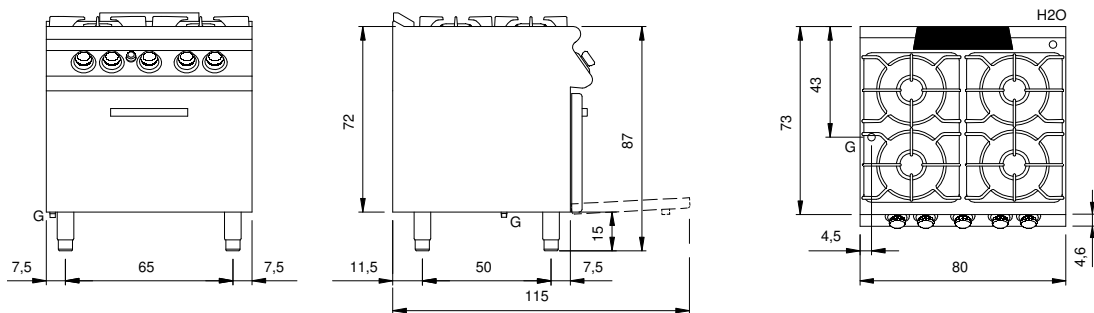

**G:** Gas connection 1/2"