

Client _____ Quantity _____
Project _____ Position _____**ROC 700**

Infrared surface 2 cooking zones, top

**Model:** R70/40PVE/T**Cod:** MP01094123001**Technical data**

Modularity:	Top
Dimension (mm):	400x730x280
Total electric power (kW):	5
Electric power (V):	380-415
Ampere (A):	11,5
Phases:	3N
Cable section (mmq):	5G2,5
Frequency (Hz):	50/60
Net volume (m3):	0,082
Packing dimensions (mm):	480x856x475
Gross weight (Kg):	25,4
Gross volume (m3):	0,195

Features

Working top:	Made of AISI 304 stainless steel with a thickness of 20/10 mm
Knobs:	Made of aluminum with IPX5 water protection
Flue:	Removable gas exhaust flue grill made of cast iron

Technical draw

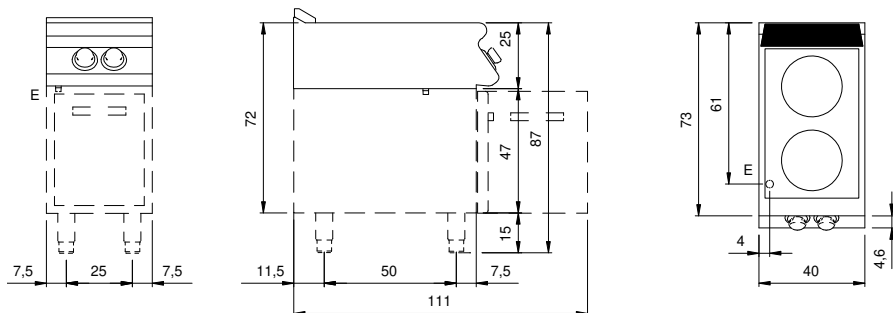

E: Electric power