



Client _____ Quantity _____
 Project _____ Position _____

ROC 700

Electric griddle, smooth chromed plate, on cabinet with door

Model: R70/40FTE/CL/P

Cod: MP01374123006

Technical data

Modularity:	On cabinet with door
Dimension (mm):	400x730x870
Total electric power (kW):	5,4
Cooking zone dimensions 1 (LxD mm):	335x530
Electric power (V):	380-415
Ampere (A):	8,5
Phases:	3N
Cable section (mmq):	5G1,5
Frequency (Hz):	50-60
Net volume (m3):	0,254
Packing dimensions (mm):	480x856x1075
Gross weight (Kg):	64,6
Gross volume (m3):	0,442

Features

Working top:	Made of AISI 304 stainless steel with a thickness of 20/10 mm
Material of plate:	Chrome
Plate finish:	Smooth
Knobs:	Made of aluminum with IPX5 water protection
Handles:	The brushed aluminum handles allow for a secure and sturdy grip with ergonomic lines
Flue:	Removable gas exhaust flue grill made of cast iron
Liquid collection container:	Removable and dishwasher safe
Plate:	Chromed
Upright Splash guard:	On two sides (optional)

Technical draw

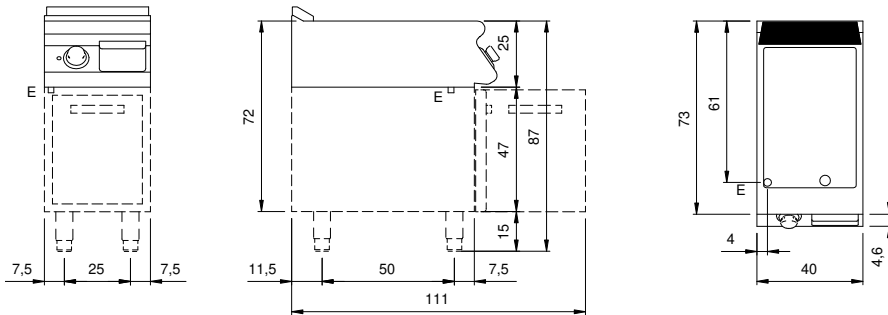

E: Electric power