



Client \_\_\_\_\_ Quantity \_\_\_\_\_  
 Project \_\_\_\_\_ Position \_\_\_\_\_

## ROC 700

Electric griddle, ribbed chromed plate, on cabinet with door

**Model:** R70/40FTE/CR/P

**Cod:** MP01374123012

### Technical data

|  |                      |
|--|----------------------|
| <b>Modularity:</b>                         | On cabinet with door |
| <b>Dimension (mm):</b>                     | 400x730x870          |
| <b>Total electric power (kW):</b>          | 5,4                  |
| <b>Cooking zone dimensions 1 (LxD mm):</b> | 335x530              |
| <b>Electric power (V):</b>                 | 380-415              |
| <b>Ampere (A):</b>                         | 8,5                  |
| <b>Phases:</b>                             | 3N                   |
| <b>Cable section (mmq):</b>                | 5G1,5                |
| <b>Frequency (Hz):</b>                     | 50-60                |
| <b>Net volume (m3):</b>                    | 0,254                |
| <b>Packing dimensions (mm):</b>            | 480x856x1075         |
| <b>Gross weight (Kg):</b>                  | 64,6                 |
| <b>Gross volume (m3):</b>                  | 0,442                |

### Features

|                                     |  |
|-------------------------------------|--|
| <b>Working top:</b>                 | Made of AISI 304 stainless steel with a thickness of 20/10 mm                        |
| <b>Material of plate:</b>           | Chrome   |
| <b>Plate finish:</b>                | Ribbed   |
| <b>Knobs:</b>                       | Made of aluminum with IPX5 water protection  |
| <b>Handles:</b>                     | The brushed aluminum handles allow for a secure and sturdy grip with ergonomic lines |
| <b>Flue:</b>                        | Removable gas exhaust flue grill made of cast iron                                   |
| <b>Liquid collection container:</b> | Removable and dishwasher safe  |
| <b>Plate:</b>                       | Chromed  |
| <b>Upright Splash guard:</b>        | On two sides (optional)  |

Technical draw

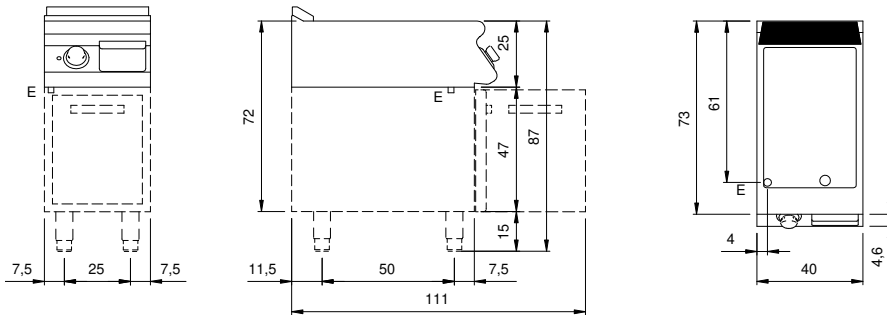

E: Electric power