



Client \_\_\_\_\_ Quantity \_\_\_\_\_  
 Project \_\_\_\_\_ Position \_\_\_\_\_

## ROC 700

Electric griddle, smooth chromed plate, on open cabinet

**Model:** R70/80FTE/CL/A

**Cod:** MP01374123017

## Technical data

<b>Modularity:</b>	On open cabinet
<b>Dimension (mm):</b>	800x730x870
<b>Total electric power (kW):</b>	10,8
<b>Cooking zone dimensions 1 (LxD mm):</b>	735x530
<b>Electric power (V):</b>	380-415
<b>Ampere (A):</b>	16,5
<b>Phases:</b>	3N
<b>Cable section (mmq):</b>	5G2,5
<b>Frequency (Hz):</b>	50-60
<b>Net volume (m3):</b>	0,508
<b>Packing dimensions (mm):</b>	880x856x1109
<b>Gross weight (Kg):</b>	103
<b>Gross volume (m3):</b>	0,835

## Features

<b>Working top:</b>	Made of AISI 304 stainless steel with a thickness of 20/10 mm
<b>Material of plate:</b>	Chrome
<b>Plate finish:</b>	Smooth
<b>Knobs:</b>	Made of aluminum with IPX5 water protection
<b>Flue:</b>	Removable gas exhaust flue grill made of cast iron
<b>Liquid collection container:</b>	Removable and dishwasher safe
<b>Plate:</b>	Chromed
<b>Upright Splash guard:</b>	On two sides (optional)

**Technical draw**

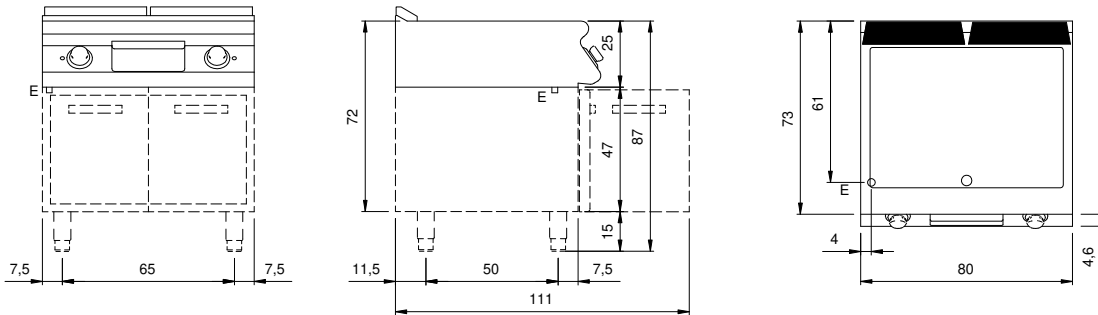

E: Electric power