

Client _____ Quantity _____
 Project _____ Position _____

ROC 700

Electric griddle, smooth mild steel plate, top



Model: R70/40FTE/L/T

Cod: MP01374123001

Market:

Extra UE

Technical data

| | |
|--|-------------|
| Modularity: | Top |
| Dimension (mm): | 400x730x280 |
| Total electric power (kW): | 5,4 |
| Cooking zone dimensions 1 (LxD mm): | 335x530 |
| Electric power (V): | 380-415 |
| Ampere (A): | 8,5 |
| Phases: | 3N |
| Cable section (mmq): | 5G1,5 |
| Frequency (Hz): | 50-60 |
| Net volume (m3): | 0,082 |
| Packing dimensions (mm): | 480x856x475 |
| Gross weight (Kg): | 48,4 |
| Gross volume (m3): | 0,195 |

Features

| | |
|-------------------------------------|---|
| Working top: | Made of AISI 304 stainless steel with a thickness of 20/10 mm |
| Material of plate: | Iron |
| Plate finish: | Smooth |
| Knobs: | Made of aluminum with IPX5 water protection |
| Flue: | Removable gas exhaust flue grill made of cast iron |
| Liquid collection container: | Removable and dishwasher safe |
| Plate: | In mild steel |
| Upright Splash guard: | On two sides (optional) |

Technical draw

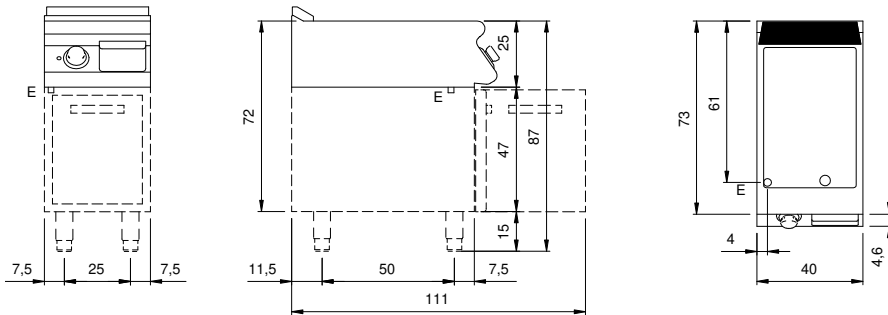

E: Electric power