



Client _____ Quantity _____
Project _____ Position _____

ROC 700

Electric griddle, smooth mild steel plate, on open cabinet

Model: R70/80FTE/L/A

Cod: MP01374123014

Market:

Extra UE

Technical data

Modularity:	On open cabinet
Dimension (mm):	800x730x870
Total electric power (kW):	10,8
Cooking zone dimensions 1 (LxD mm):	735x530
Electric power (V):	380-415
Ampere (A):	16,5
Phases:	3N
Cable section (mmq):	5G2,5
Frequency (Hz):	50-60
Net volume (m3):	0,508
Packing dimensions (mm):	880x856x1109
Gross weight (Kg):	103
Gross volume (m3):	0,835

Features

Working top:	Made of AISI 304 stainless steel with a thickness of 20/10 mm
Material of plate:	Iron
Plate finish:	Smooth
Knobs:	Made of aluminum with IPX5 water protection
Flue:	Removable gas exhaust flue grill made of cast iron
Liquid collection container:	Removable and dishwasher safe
Plate:	In mild steel
Upright Splash guard:	On two sides (optional)

Technical draw

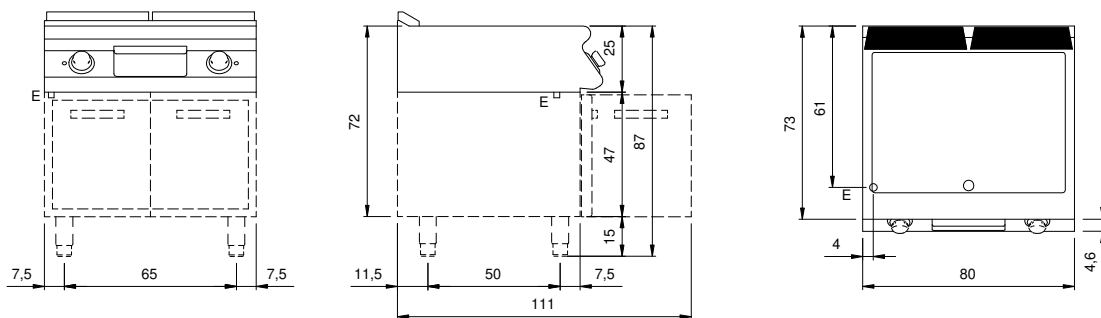

E: Electric power