

Client _____ Quantity _____
 Project _____ Position _____



ROC 700

Induction plate, 2 cooking zones, on open cabinet

Model: R70/40IND/A

Cod: MP01134123001

Technical data

Modularity:	On open cabinet
Dimension (mm):	400x730x870
Total electric power (kW):	7
Electric power (V):	380-415
Ampere (A):	11
Phases:	3N
Cable section (mmq):	5G2,5
Frequency (Hz):	50-60
Net volume (m3):	0,254
Packing dimensions (mm):	480x856x1075
Gross weight (Kg):	63,3
Gross volume (m3):	0,442

Features

Working top:	Made of AISI 304 stainless steel with a thickness of 20/10 mm
Knobs:	Made of aluminum with IPX5 water protection
Flue:	Removable gas exhaust flue grill made of cast iron

In order to constantly offer the best possible products we reserve the right to make changes on technical specifications without incurring any obligation for equipment previously or subsequently sold.

Technical draw

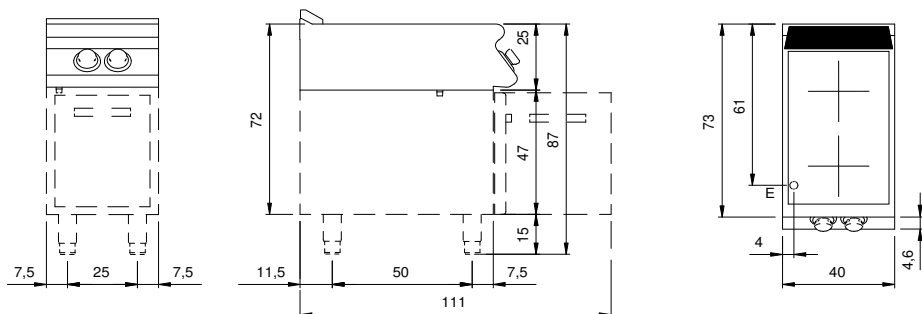

E: Electric power