



Client _____ Quantity _____
 Project _____ Position _____

ROC 700

Gas griddle, ribbed chromed plate, on cabinet with door

Model: R70/40FTG/CR/P

Cod: MP01374113012

Technical data

| | |
|--|----------------------|
| Modularity: | On cabinet with door |
| Dimension (mm): | 400x730x870 |
| Total gas power (Kcal/h): | 6019 |
| Total gas power (kW): | 7 |
| Cooking zone dimensions 1 (LxD mm): | 335x530 |
| Gas connection: | 1/2" |
| Net volume (m3): | 0,254 |
| Packing dimensions (mm): | 480x856x1075 |
| Gross weight (Kg): | 68,3 |
| Gross volume (m3): | 0,442 |

Features

| | |
|-------------------------------------|--|
| Working top: | Made of AISI 304 stainless steel with a thickness of 20/10 mm |
| Material of plate: | Chrome |
| Plate finish: | Ribbed |
| Knobs: | Made of aluminum with IPX5 water protection |
| Handles: | The brushed aluminum handles allow for a secure and sturdy grip with a ergonomic lines |
| Flue: | Removable gas exhaust flue grill made of cast iron |
| Liquid collection container: | Removable and dishwasher safe |
| Plate: | Chromed |
| Upright Splash guard: | On two sides (optional) |
| Kit Gas: | natural gas conversion kit 30/50 m/bar (tested with natural gas G20) |

In order to constantly offer the best possible products we reserve the right to make changes on technical specifications without incurring any obligation for equipment previously or subsequently sold.

Technical draw

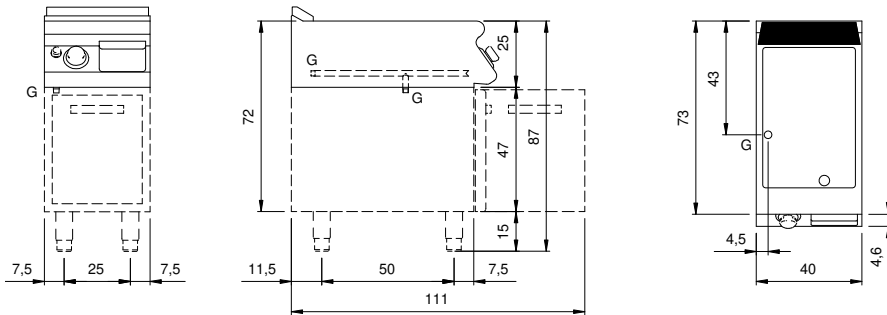

G: Gas connection 1/2"