

Client \_\_\_\_\_ Quantity \_\_\_\_\_  
 Project \_\_\_\_\_ Position \_\_\_\_\_



## ROC 900

Electric bain marie, on cabinet with door

**Model:** R90/40BME/P

**Cod:** MP01254124002

### Technical data

<b>Modularity:</b>	On cabinet with door
<b>Dimension (mm):</b>	400x900x870
<b>Total electric power (kW):</b>	2,2
<b>Nr. Wells:</b>	1
<b>Well litres 1:</b>	25
<b>Well dimensions 1 (mm):</b>	351x685x155
<b>Electric power (V):</b>	220-240
<b>Ampere (A):</b>	10
<b>Phases:</b>	1
<b>Cable section (mmq):</b>	3G1,5
<b>Frequency (Hz):</b>	50-60
<b>Drain size:</b>	1"
<b>Net volume (m3):</b>	0,313
<b>Packing dimensions (mm):</b>	480x1026x1075
<b>Gross weight (Kg):</b>	53,6
<b>Gross volume (m3):</b>	0,529

### Features

<b>Working top:</b>	Made of AISI 304 stainless steel with a thickness of 20/10 mm
<b>Knobs:</b>	Made of aluminum with IPX5 water protection
<b>Handles:</b>	The brushed aluminum handles allow for a secure and sturdy grip with ergonomic lines
<b>Water inflow:</b>	Manual input

**Technical draw**

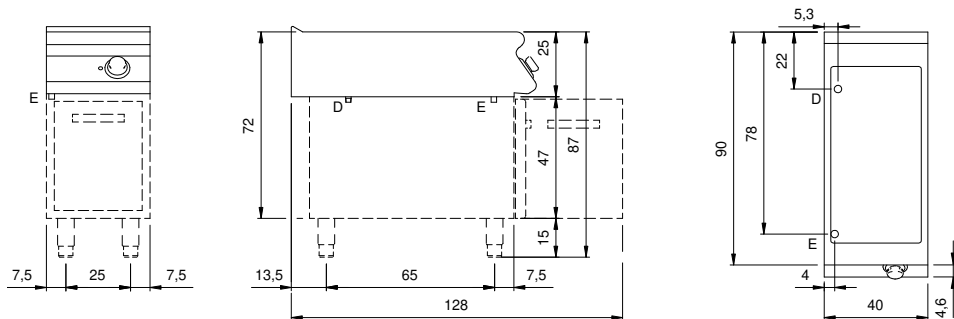

**E:** Electric power

**D:** Drain for water