



Client _____ Quantity _____
Project _____ Position _____

ROC 900

Electric range, 4 round plates, on open cabinet

Model: R90/80PCEQ/A

Cod: MP01014124005

Technical data

Modularity:	On open cabinet
Dimension (mm):	800x900x870 mm
Total electric power (kW):	16
Electric power (V):	380-415
Ampere (A):	36,5
Phases:	3N
Cable section (mmq):	5G6
Frequency (Hz):	50-60
Net volume (m3):	0,626
Packing dimensions (mm):	880x1026x1109 mm
Gross weight (Kg):	103
Gross volume (m3):	1,001

Features

Working top:	Made of AISI 304 stainless steel with a thickness of 20/10 mm
Knobs:	Made of aluminum with IPX5 water protection
Flue:	Removable made of cast iron

Technical draw

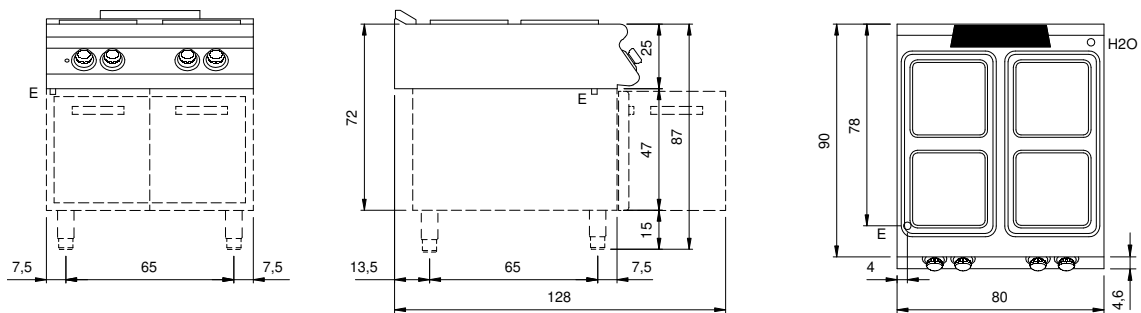

E: Electric power