



Client \_\_\_\_\_ Quantity \_\_\_\_\_  
 Project \_\_\_\_\_ Position \_\_\_\_\_

**ROC 900**

Electric range, 4 round plates, on cabinet with doors

**Model:** R90/80PCEQ/P

**Cod:** MP01014124006

**Technical data**

<b>Modularity:</b>	On cabinet with doors
<b>Dimension (mm):</b>	800x900x870 mm
<b>Total electric power (kW):</b>	16
<b>Electric power (V):</b>	380-415
<b>Ampere (A):</b>	36,5
<b>Phases:</b>	3N
<b>Cable section (mmq):</b>	5G6
<b>Frequency (Hz):</b>	50-60
<b>Net volume (m3):</b>	0,626
<b>Packing dimensions (mm):</b>	880x1026x1109 mm
<b>Gross weight (Kg):</b>	110
<b>Gross volume (m3):</b>	1,001

**Features**

<b>Working top:</b>	Made of AISI 304 stainless steel with a thickness of 20/10 mm
<b>Knobs:</b>	Made of aluminum with IPX5 water protection
<b>Handles:</b>	The brushed aluminum handles allow for a secure and sturdy grip with a ergonomic lines
<b>Flue:</b>	Removable made of cast iron

In order to constantly offer the best possible products we reserve the right to make changes on technical specifications without incurring any obligation for equipment previously or subsequently sold.

**Technical draw**

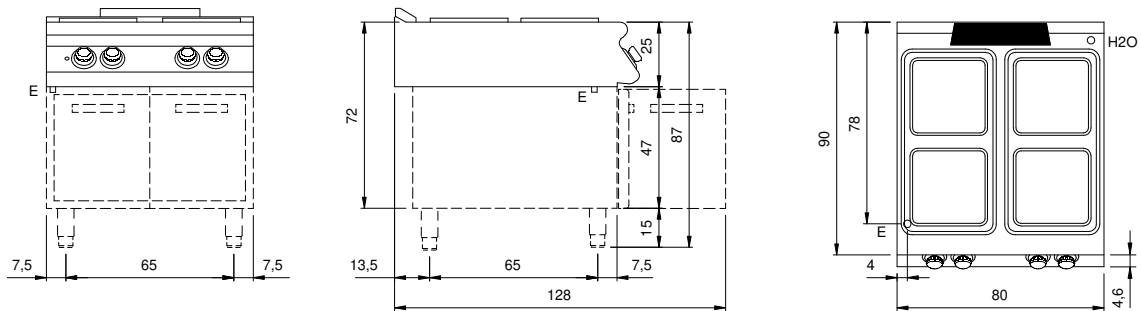

**E:** Electric power