



Client _____ Quantity _____
 Project _____ Position _____

ROC 900

Gas range pressed worktop, 2 burners, on cabinet with door

Model: R90/40PCG/P

Cod: MP01014114002

Technical data

Modularity:	On cabinet with door
Dimension (mm):	400x900x870 mm
Total gas power (Kcal/h):	13758
Total gas power (kW):	16
Gas connection:	1/2"
Net volume (m3):	0,313
Packing dimensions (mm):	480x1026x1075 mm
Gross weight (Kg):	61,6
Burner power 1 (kW):	6
Burner power 2 (kW):	10
Gross volume (m3):	0,529

Features

Burners:	Single and double crown cast iron burners with brass burner cap
Grill:	For single burner in cast iron or stainless steel (optional) dishwasher safe
Working top:	Pressed top made of AISI 304 stainless steel 20/10 mm thick
Knobs:	Made of aluminum with IPX5 water protection
Handles:	The brushed aluminum handles allow for a secure and sturdy grip with a ergonomic lines
Kit Gas:	natural gas conversion kit 30/50 m/bar (tested with natural gas G20)

In order to constantly offer the best possible products we reserve the right to make changes on technical specifications without incurring any obligation for equipment previously or subsequently sold.

Technical draw

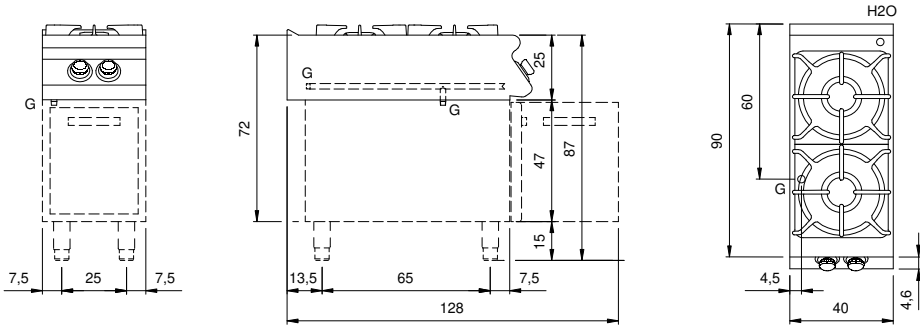

G: Gas connection 1/2"