

Client _____ Quantity _____
Project _____ Position _____**ROC 900**

Gas range pressed worktop, 4 burners, top

**Model:** R90/80PCG/T**Cod:** MP01014114003**Technical data**

Modularity:	Top
Dimension (mm):	800x900x280
Total gas power (Kcal/h):	30955
Total gas power (kW):	36
Gas connection:	1/2"
Net volume (m3):	0,202
Packing dimensions (mm):	880x1026x509
Gross weight (Kg):	75
Burner power 1 (kW):	6
Burner power 2 (kW):	10
Burner power 3 (kW):	10
Burner power 4 (kW):	10
Gross volume (m3):	0,460

Features

Burners:	Single and double crown cast iron burners with brass burner cap
Grill:	For single burner in cast iron or stainless steel (optional) dishwasher safe
Working top:	Pressed top made of AISI 304 stainless steel 20/10 mm thick
Knobs:	Made of aluminum with IPX5 water protection
Kit Gas:	natural gas conversion kit 30/50 m/bar (tested with natural gas G20)

Technical draw

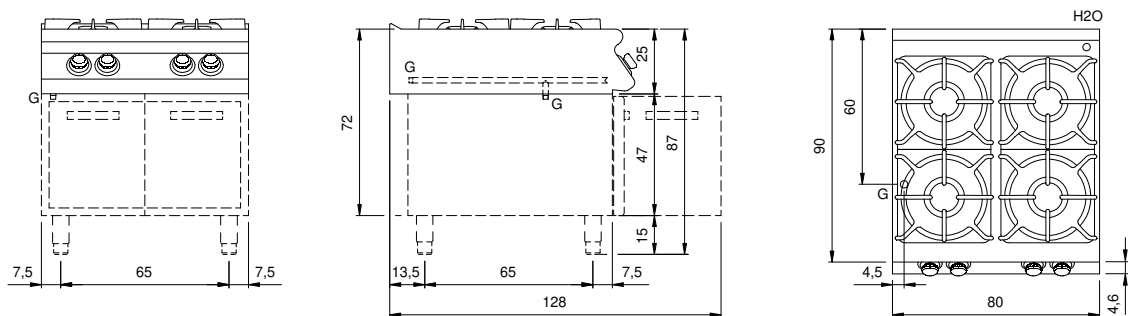

G: Gas connection 1/2"