



Client _____ Quantity _____
 Project _____ Position _____

ROC 900

Gas range pressed worktop, 6 burners, gas oven

Model: R90/120CFG

Cod: MP01034114001

Technical data

Modularity:	Gas oven
Dimension (mm):	1200x900x870
Dimensione forno (mm):	555x660x289
Total gas power (Kcal/h):	51591
Total gas power (kW):	60
Oven type:	Static oven
Oven power (kW):	8
Oven temperature range (°C):	95-300
Gas connection:	1/2"
Net volume (m3):	0,94
Packing dimensions (mm):	1280x1026x1109
Gross weight (Kg):	186,6
Burner power 1 (kW):	6
Burner power 2 (kW):	10
Burner power 3 (kW):	10
Burner power 4 (kW):	10
Gross volume (m3):	1,456

Features

Burners:	Single and double crown cast iron burners with brass burner cap
Grill:	For single burner in cast iron or stainless steel (optional) dishwasher safe
Working top:	Pressed top made of AISI 304 stainless steel 20/10 mm thick
Knobs:	Made of aluminum with IPX5 water protection
Handles:	The brushed aluminum handles allow for a secure and sturdy grip with a ergonomic lines
Flue:	Removable made of cast iron
Kit Gas:	natural gas conversion kit 30/50 m/bar (tested with natural gas G20)

Technical draw

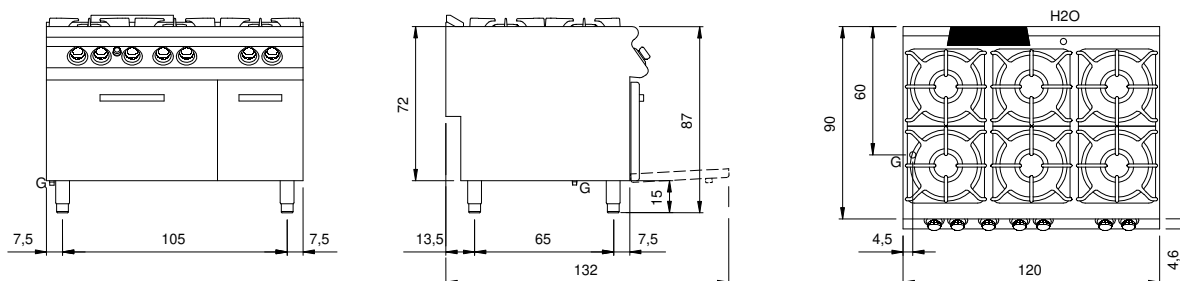

G: Gas connection 1/2"