

Client _____ Quantity _____
 Project _____ Position _____

FUN 700

Gas range enamelled containers, 2 burners, top



Model: F70/40PCGB/T

Cod: MP01012113002

Technical data

| | |
|----------------------------------|----------------|
| Modularity: | Top |
| Dimension (mm): | 400x700x300 mm |
| Total gas power (Kcal/h): | 7911 |
| Total gas power (kW): | 9,2 |
| Gas connection: | 1/2" |
| Net volume (m3): | 0,084 |
| Packing dimensions (mm): | 477x776x612 mm |
| Gross weight (Kg): | 29 |
| Burner power 1 (kW): | 5,5 |
| Burner power 2 (kW): | 3,7 |
| Gross volume (m3): | 0,227 |

Features

| | |
|---------------------|--|
| Burners: | Double or single crown cast iron version available with a pilot light |
| Grill: | Cast-iron with brass single- and double-crown burner with pilot |
| Working top: | Made of AISI 304 stainless steel with a thickness of 10/10 mm and removable enamelled containers |
| Knobs: | Knobs are made from a sturdy heat-resistant polymer blend and are equipped with liquid anti-leakage washer |
| Kit Gas: | natural gas conversion kit 30/50 m/bar (tested with natural gas G20) |

Technical draw

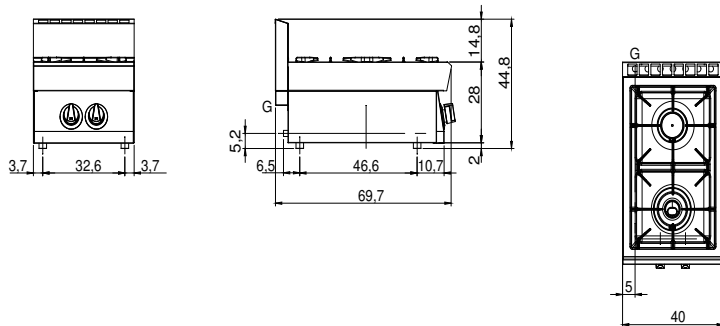

G: Gas connection 1/2"