



Client \_\_\_\_\_ Quantity \_\_\_\_\_  
Project \_\_\_\_\_ Position \_\_\_\_\_

## ROC 900

Infrared surface 2 cooking zones, on open cabinet

**Model:** R90/40PVE/A

**Cod:** MP01094124002

## Technical data

<b>Modularity:</b>	On open cabinet
<b>Dimension (mm):</b>	400x900x870
<b>Total electric power (kW):</b>	6,8
<b>Electric power (V):</b>	380-415
<b>Ampere (A):</b>	15,5
<b>Phases:</b>	3N
<b>Cable section (mmq):</b>	5G2,5
<b>Frequency (Hz):</b>	50-60
<b>Net volume (m3):</b>	0,313
<b>Packing dimensions (mm):</b>	480x1026x1075
<b>Gross weight (Kg):</b>	50,1
<b>Gross volume (m3):</b>	0,529

## Features

<b>Working top:</b>	Made of AISI 304 stainless steel with a thickness of 20/10 mm
<b>Knobs:</b>	Made of aluminum with IPX5 water protection
<b>Flue:</b>	Removable made of cast iron

**Technical draw**

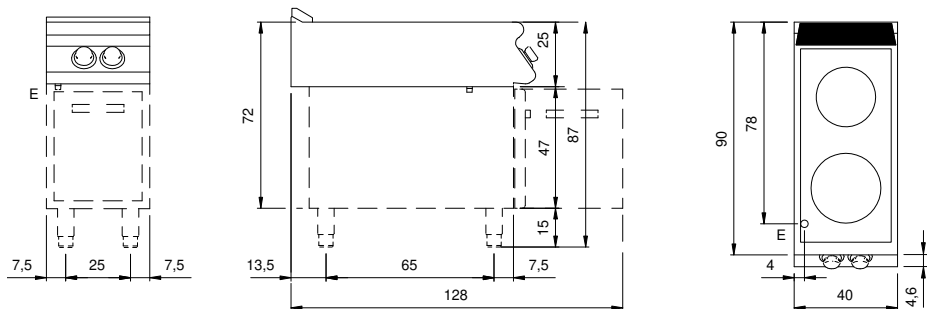

**E:** Electric power