

Client _____ Quantity _____
 Project _____ Position _____



ROC 900

Infrared surface 2 cooking zones, on cabinet with door

Model: R90/40PVE/P

Cod: MP01094124003

Technical data

Modularity:	On cabinet with door
Dimension (mm):	400x900x870
Total electric power (kW):	6,8
Electric power (V):	380-415
Ampere (A):	15,5
Phases:	3N
Cable section (mmq):	5G2,5
Frequency (Hz):	50-60
Net volume (m3):	0,313
Packing dimensions (mm):	480x1026x1075
Gross weight (Kg):	53,1
Gross volume (m3):	0,529

Features

Working top:	Made of AISI 304 stainless steel with a thickness of 20/10 mm
Knobs:	Made of aluminum with IPX5 water protection
Handles:	The brushed aluminum handles allow for a secure and sturdy grip with ergonomic lines
Flue:	Removable made of cast iron

In order to constantly offer the best possible products we reserve the right to make changes on technical specifications without incurring any obligation for equipment previously or subsequently sold.

Technical draw

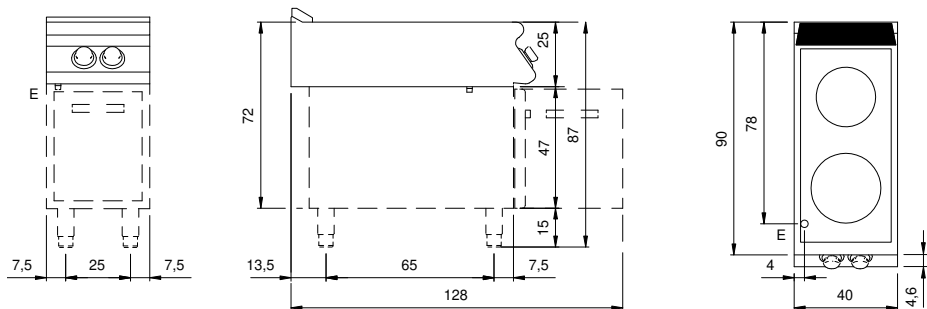

E: Electric power