

Client \_\_\_\_\_ Quantity \_\_\_\_\_  
 Project \_\_\_\_\_ Position \_\_\_\_\_



**ROC 900**

Electric griddle, ribbed chromed plate, on open cabinet

**Model:** R90/40FTE/CR/A

**Cod:** MP01374124011

**Technical data**

<b>Modularity:</b>	On open cabinet
<b>Dimension (mm):</b>	400x900x870
<b>Total electric power (kW):</b>	7,5
<b>Cooking zone dimensions 1 (LxD mm):</b>	335x700
<b>Electric power (V):</b>	380-415
<b>Ampere (A):</b>	11,5
<b>Phases:</b>	3N
<b>Cable section (mmq):</b>	5G1,5
<b>Frequency (Hz):</b>	50-60
<b>Net volume (m3):</b>	0,313
<b>Packing dimensions (mm):</b>	480x1026x1075
<b>Gross weight (Kg):</b>	75,1
<b>Gross volume (m3):</b>	0,529

**Features**

<b>Working top:</b>	Made of AISI 304 stainless steel with a thickness of 20/10 mm
<b>Material of plate:</b>	Chrome
<b>Plate finish:</b>	Ribbed
<b>Knobs:</b>	Made of aluminum with IPX5 water protection
<b>Flue:</b>	Removable made of cast iron
<b>Liquid collection container:</b>	Removable and dishwasher safe
<b>Plate:</b>	Chromed
<b>Upright Splash guard:</b>	On two sides (optional)

In order to constantly offer the best possible products we reserve the right to make changes on technical specifications without incurring any obligation for equipment previously or subsequently sold.

**Technical draw**

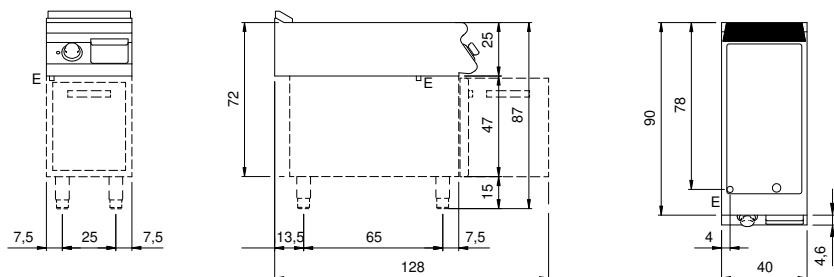

E: Electric power