

Client \_\_\_\_\_ Quantity \_\_\_\_\_  
Project \_\_\_\_\_ Position \_\_\_\_\_



## ROC 900

Electric griddle, ribbed chromed plate, on cabinet with door

**Model:** R90/40FTE/CR/P

**Cod:** MP01374124012

### Technical data

<b>Modularity:</b>	On cabinet with door
<b>Dimension (mm):</b>	400x900x870
<b>Total electric power (kW):</b>	7,5
<b>Cooking zone dimensions 1 (LxD mm):</b>	335x700
<b>Electric power (V):</b>	380-415
<b>Ampere (A):</b>	11,5
<b>Phases:</b>	3N
<b>Cable section (mmq):</b>	5G1,5
<b>Frequency (Hz):</b>	50-60
<b>Net volume (m3):</b>	0,313
<b>Packing dimensions (mm):</b>	480x1026x1075
<b>Gross weight (Kg):</b>	78,6
<b>Gross volume (m3):</b>	0,529

### Features

<b>Working top:</b>	Made of AISI 304 stainless steel with a thickness of 20/10 mm
<b>Material of plate:</b>	Chrome
<b>Plate finish:</b>	Ribbed
<b>Knobs:</b>	Made of aluminum with IPX5 water protection
<b>Handles:</b>	The brushed aluminum handles allow for a secure and sturdy grip with a ergonomic lines
<b>Flue:</b>	Removable made of cast iron
<b>Liquid collection container:</b>	Removable and dishwasher safe
<b>Plate:</b>	Chromed
<b>Upright Splash guard:</b>	On two sides (optional)

**Technical draw**

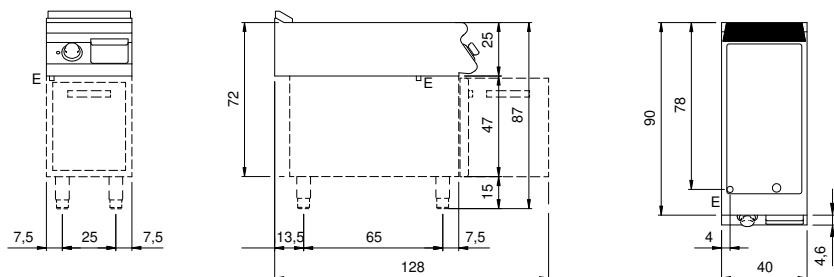

E: Electric power