

Client _____ Quantity _____
 Project _____ Position _____



ROC 900

Electric griddle, ribbed mild steel plate, on open cabinet

Model: R90/40FTE/R/A

Cod: MP01374124008

Market:

Extra UE

Technical data

Modularity:	On open cabinet
Dimension (mm):	400x900x870
Total electric power (kW):	7,5
Cooking zone dimensions 1 (LxD mm):	335x700
Electric power (V):	380-415
Ampere (A):	11,5
Phases:	3N
Cable section (mmq):	5G1,5
Frequency (Hz):	50-60
Net volume (m3):	0,313
Packing dimensions (mm):	480x1026x1075
Gross weight (Kg):	75,1
Gross volume (m3):	0,529

Features

Working top:	Made of AISI 304 stainless steel with a thickness of 20/10 mm
Material of plate:	Iron
Plate finish:	Ribbed
Knobs:	Made of aluminum with IPX5 water protection
Flue:	Removable made of cast iron
Liquid collection container:	Removable and dishwasher safe
Plate:	In mild steel
Upright Splash guard:	On two sides (optional)

Technical draw

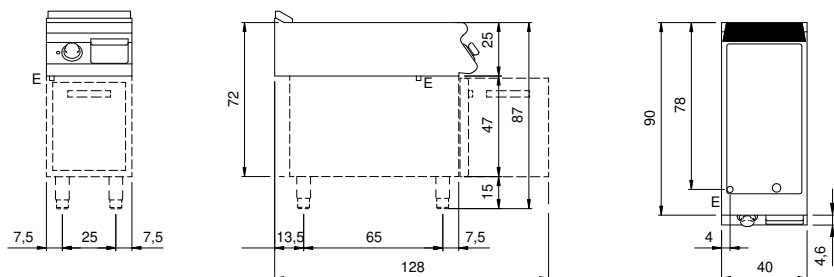

E: Electric power