

Client _____ Quantity _____
Project _____ Position _____

ROC 900

Electric griddle, ribbed chromed plate, top



Model: R90/40FTE/CR/T

Cod: MP01374124010

Technical data

Modularity:	Top
Dimension (mm):	400x900x280
Total electric power (kW):	7,5
Cooking zone dimensions 1 (LxD mm):	335x700
Electric power (V):	380-415
Ampere (A):	11,5
Phases:	3N
Cable section (mmq):	5G1,5
Frequency (Hz):	50-60
Net volume (m3):	0,101
Packing dimensions (mm):	480x1026x475
Gross weight (Kg):	60,6
Gross volume (m3):	0,234

Features

Working top:	Made of AISI 304 stainless steel with a thickness of 20/10 mm
Material of plate:	Chrome
Plate finish:	Ribbed
Knobs:	Made of aluminum with IPX5 water protection
Flue:	Removable made of cast iron
Liquid collection container:	Removable and dishwasher safe
Plate:	Chromed
Upright Splash guard:	On two sides (optional)

Technical draw

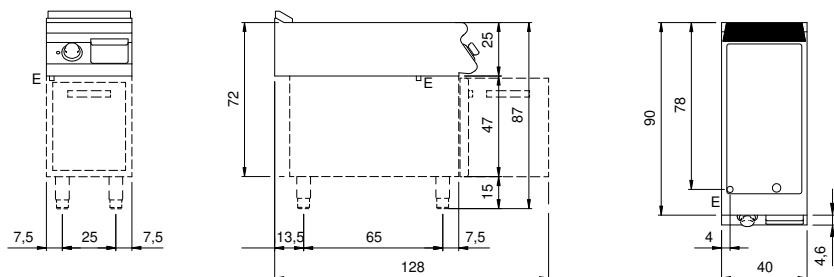

E: Electric power