

Client _____ Quantity _____
 Project _____ Position _____

ROC 900

Electric griddle, 2/3 smooth 1/3 ribbed chromed plate, top



Model: R90/80FTE/CLR/T **Cod:** MP01374124022

Technical data

Modularity:	Top
Dimension (mm):	800x900x280
Total electric power (kW):	15
Cooking zone dimensions 1 (LxD mm):	735x700
Electric power (V):	380-415
Ampere (A):	23
Phases:	3N
Cable section (mmq):	5G4
Frequency (Hz):	50-60
Net volume (m3):	0,202
Packing dimensions (mm):	880x1026x509
Gross weight (Kg):	107,4
Gross volume (m3):	0,460

Features

Working top:	Made of AISI 304 stainless steel with a thickness of 20/10 mm
Material of plate:	Chrome
Knobs:	Made of aluminum with IPX5 water protection
Flue:	Removable made of cast iron
Liquid collection container:	Removable and dishwasher safe
Plate:	Chromed
Upright Splash guard:	On two sides (optional)

Technical draw

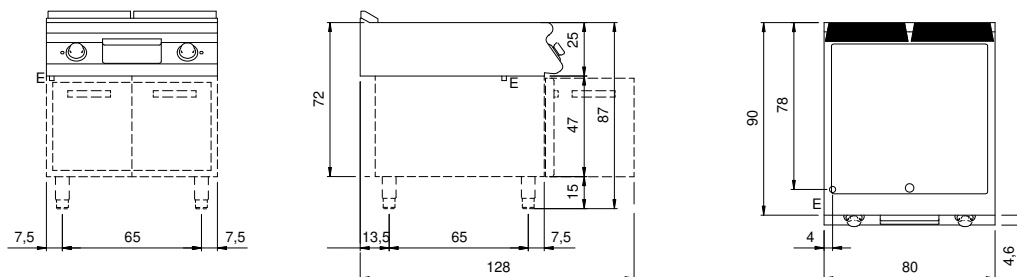

E: Electric power