



Client _____ Quantity _____
 Project _____ Position _____

ROC 900

Electric griddle, 2/3 smooth 1/3 ribbed chromed plate, on open cabinet

Model: R90/80FTE/CLR/A **Cod:** MP01374124023

Technical data

Modularity:	On open cabinet
Dimension (mm):	800x900x870
Total electric power (kW):	15
Cooking zone dimensions 1 (LxD mm):	735x700
Electric power (V):	380-415
Ampere (A):	23
Phases:	3N
Cable section (mmq):	5G4
Frequency (Hz):	50-60
Net volume (m3):	0,626
Packing dimensions (mm):	880x1026x1109
Gross weight (Kg):	127,6
Gross volume (m3):	1,001

Features

Working top:	Made of AISI 304 stainless steel with a thickness of 20/10 mm
Material of plate:	Chrome
Knobs:	Made of aluminum with IPX5 water protection
Flue:	Removable made of cast iron
Liquid collection container:	Removable and dishwasher safe
Plate:	Chromed
Upright Splash guard:	On two sides (optional)

In order to constantly offer the best possible products we reserve the right to make changes on technical specifications without incurring any obligation for equipment previously or subsequently sold.

Technical draw

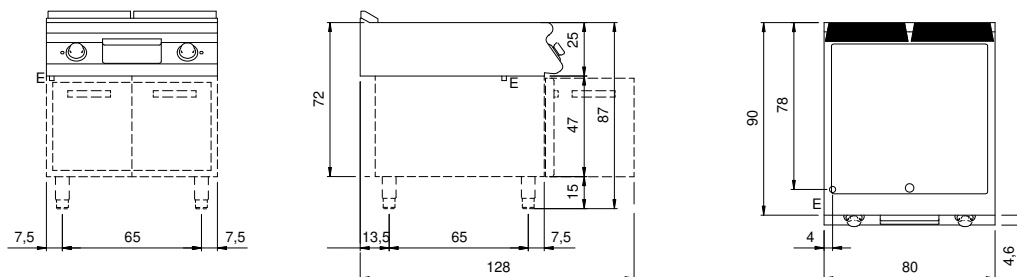

E: Electric power