

Client _____ Quantity _____
Project _____ Position _____



ROC 900

Induction plate, 2 cooking zones, on open cabinet

Model: R90/40IND/A

Cod: MP01134124001

Technical data

Modularity:	On open cabinet
Dimension (mm):	400x900x870
Total electric power (kW):	10
Electric power (V):	380-415
Ampere (A):	15,5
Phases:	3N
Cable section (mmq):	5G2,5
Frequency (Hz):	50-60
Net volume (m3):	0,101
Packing dimensions (mm):	480x1026x1075
Gross weight (Kg):	62,6
Gross volume (m3):	0,529

Features

Working top:	Made of AISI 304 stainless steel with a thickness of 20/10 mm
Knobs:	Made of aluminum with IPX5 water protection
Flue:	Removable made of cast iron

Technical draw

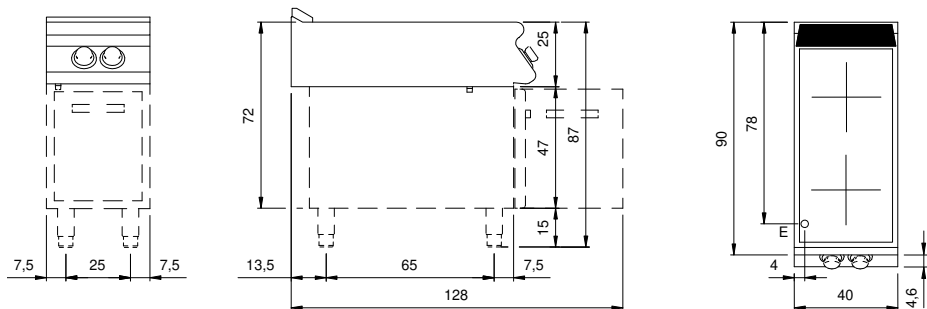

E: Electric power