

Client _____ Quantity _____
 Project _____ Position _____

ROC 900

Induction plate, 4 cooking zones, top



Model: R90/80IND/T

Cod: MP01134124003

Technical data

Modularity:	Top
Dimension (mm):	800x900x280
Total electric power (kW):	20
Electric power (V):	380-415
Ampere (A):	30,5
Phases:	3N
Cable section (mmq):	5G6
Frequency (Hz):	50-60
Net volume (m3):	0,202
Packing dimensions (mm):	880x1026x509
Gross weight (Kg):	79,9
Gross volume (m3):	0,460

Features

Working top:	Made of AISI 304 stainless steel with a thickness of 20/10 mm
Knobs:	Made of aluminum with IPX5 water protection
Flue:	Removable made of cast iron

In order to constantly offer the best possible products we reserve the right to make changes on technical specifications without incurring any obligation for equipment previously or subsequently sold.

Technical draw

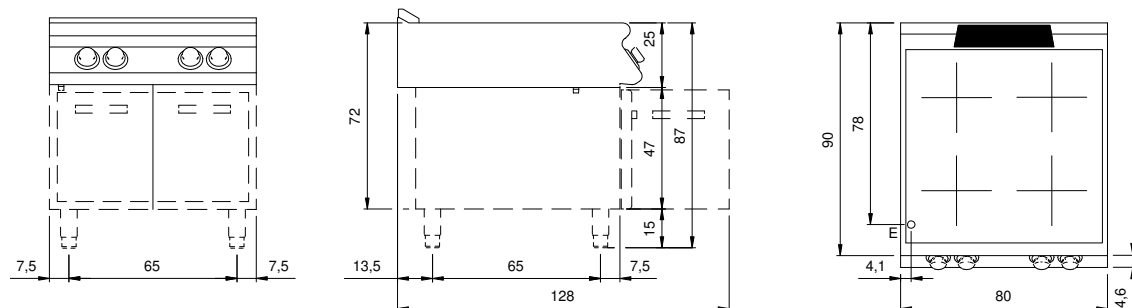

E: Electric power