



Client \_\_\_\_\_ Quantity \_\_\_\_\_  
 Project \_\_\_\_\_ Position \_\_\_\_\_

## ROC 900

Gas griddle, smooth chromed plate, on open cabinet

**Model:** R90/40FTG/CL/A

**Cod:** MP01374114005

### Technical data

<b>Modularity:</b>	On open cabinet
<b>Dimension (mm):</b>	400x900x870
<b>Total gas power (Kcal/h):</b>	9029
<b>Total gas power (kW):</b>	10,5
<b>Cooking zone dimensions 1 (LxD mm):</b>	335x700
<b>Gas connection:</b>	1/2"
<b>Net volume (m3):</b>	0,313
<b>Packing dimensions (mm):</b>	480x1026x1075
<b>Gross weight (Kg):</b>	63,5
<b>Gross volume (m3):</b>	0,529

### Features

<b>Working top:</b>	Made of AISI 304 stainless steel with a thickness of 20/10 mm
<b>Material of plate:</b>	Chrome
<b>Plate finish:</b>	Smooth
<b>Knobs:</b>	Made of aluminum with IPX5 water protection
<b>Liquid collection container:</b>	Removable and dishwasher safe
<b>Plate:</b>	Chromed
<b>Upright Splash guard:</b>	On two sides (optional)
<b>Kit Gas:</b>	natural gas conversion kit 30/50 m/bar (tested with natural gas G20)

Technical draw

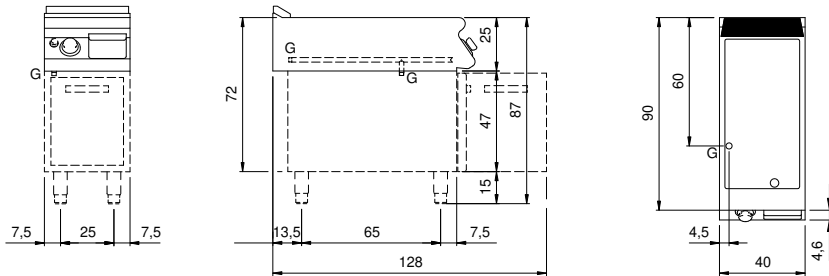

G: Gas connection 1/2"