

Client _____ Quantity _____
 Project _____ Position _____

ROC 900

Gas griddle, ribbed mild steel plate, top



Model: R90/40FTG/R/T

Cod: MP01374114007

Market:

Extra UE

Technical data

Modularity:	Top
Dimension (mm):	400x900x280
Total gas power (Kcal/h):	6019
Total gas power (kW):	7
Cooking zone dimensions 1 (LxD mm):	335x700
Gas connection:	1/2"
Net volume (m3):	0,101
Packing dimensions (mm):	480x1026x475
Gross weight (Kg):	49
Gross volume (m3):	0,234

Features

Working top:	Made of AISI 304 stainless steel with a thickness of 20/10 mm
Material of plate:	Iron
Plate finish:	Ribbed
Knobs:	Made of aluminum with IPX5 water protection
Flue:	Removable made of cast iron
Liquid collection container:	Removable and dishwasher safe
Plate:	In mild steel
Upright Splash guard:	On two sides (optional)
Kit Gas:	natural gas conversion kit 30/50 m/bar (tested with natural gas G20)

Technical draw

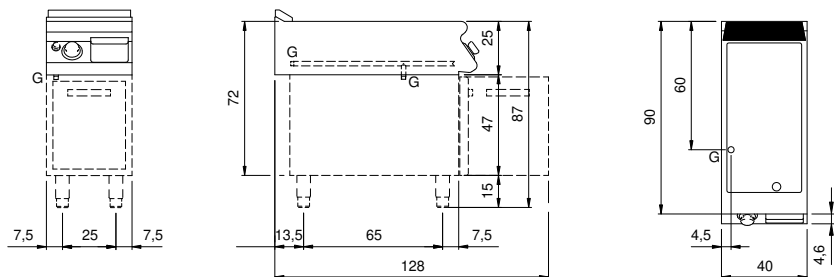

G: Gas connection 1/2"