



Client _____ Quantity _____
 Project _____ Position _____

ROC 900

Gas griddle, ribbed chromed plate, on open cabinet

Model: R90/40FTG/CR/A **Cod:** MP01374114011

Technical data

Modularity:	On open cabinet
Dimension (mm):	400x900x870
Total gas power (Kcal/h):	9029
Total gas power (kW):	10,5
Cooking zone dimensions 1 (LxD mm):	335x700
Gas connection:	1/2"
Net volume (m3):	0,313
Packing dimensions (mm):	480x1026x1075
Gross weight (Kg):	63,5
Gross volume (m3):	0,529

Features

Working top:	Made of AISI 304 stainless steel with a thickness of 20/10 mm
Material of plate:	Chrome
Plate finish:	Ribbed
Knobs:	Made of aluminum with IPX5 water protection
Liquid collection container:	Removable and dishwasher safe
Plate:	Chromed
Upright Splash guard:	On two sides (optional)
Kit Gas:	natural gas conversion kit 30/50 m/bar (tested with natural gas G20)

In order to constantly offer the best possible products we reserve the right to make changes on technical specifications without incurring any obligation for equipment previously or subsequently sold.

Technical draw

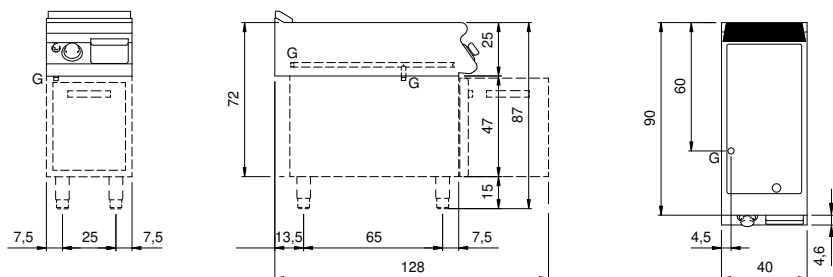

G: Gas connection 1/2"