



Client _____ Quantity _____
Project _____ Position _____

ROC 900

Gas griddle, smooth mild steel plate, on cabinet with doors

Model: R90/80FTG/L/P

Cod: MP01374114015

Market:

Extra UE

Technical data

Modularity:	On cabinet with doors
Dimension (mm):	800x900x870
Total gas power (Kcal/h):	12038
Total gas power (kW):	14
Cooking zone dimensions 1 (LxD mm):	735x700
Gas connection:	1/2"
Net volume (m3):	0,626
Packing dimensions (mm):	880x1026x1109
Gross weight (Kg):	116
Gross volume (m3):	1,001

Features

Working top:	Made of AISI 304 stainless steel with a thickness of 20/10 mm
Material of plate:	Iron
Plate finish:	Smooth
Knobs:	Made of aluminum with IPX5 water protection
Handles:	The brushed aluminum handles allow for a secure and sturdy grip with a ergonomic lines
Flue:	Removable made of cast iron
Liquid collection container:	Removable and dishwasher safe
Plate:	In mild steel
Upright Splash guard:	On two sides (optional)
Kit Gas:	natural gas conversion kit 30/50 m/bar (tested with natural gas G20)

Technical draw

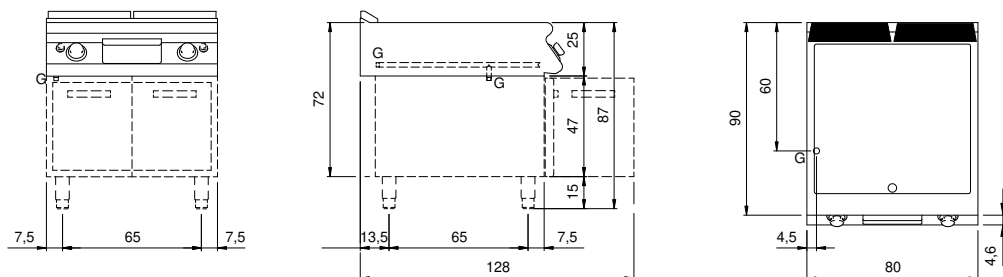

G: Gas connection 1/2"