

Client _____ Quantity _____
 Project _____ Position _____

ROC 900

Gas griddle, 2/3 smooth 1/3 ribbed chromed plate, top



Model: R90/80FTG/CLR/T **Cod:** MP01374114022

Technical data

Modularity:	Top
Dimension (mm):	800x900x280
Total gas power (Kcal/h):	18057
Total gas power (kW):	21
Cooking zone dimensions 1 (LxD mm):	735x700
Gas connection:	1/2"
Net volume (m3):	0,202
Packing dimensions (mm):	880x1026x509
Gross weight (Kg):	90
Gross volume (m3):	0,460

Features

Working top:	Made of AISI 304 stainless steel with a thickness of 20/10 mm
Material of plate:	Chrome
Knobs:	Made of aluminum with IPX5 water protection
Liquid collection container:	Removable and dishwasher safe
Plate:	Chromed
Upright Splash guard:	On two sides (optional)
Kit Gas:	natural gas conversion kit 30/50 m/bar (tested with natural gas G20)

Technical draw

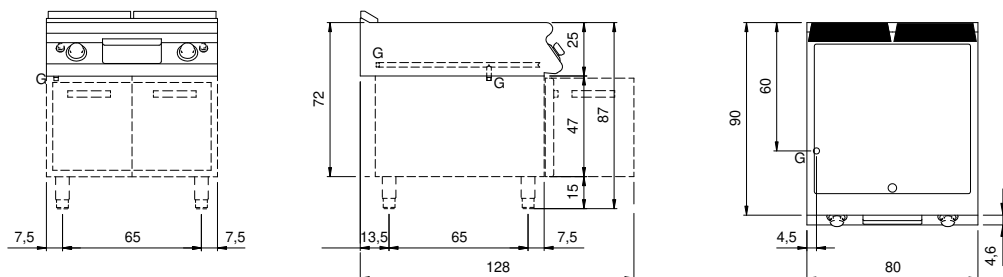

G: Gas connection 1/2"