



Client \_\_\_\_\_ Quantity \_\_\_\_\_  
 Project \_\_\_\_\_ Position \_\_\_\_\_

**ROC 900**

Lava-stone grill, 1 cooking zone in stainless steel, on cabinet with door

**Model:** R90/40GRLI/P

**Cod:** MP01454114013

**Technical data**

<b>Modularity:</b>	On cabinet with door
<b>Packing dimensions (mm):</b>	480x1026x1240
<b>Gross weight (Kg):</b>	75
<b>Gross volume (m3):</b>	0,611

**Features**

<b>Grill:</b>	In stainless steel
<b>Working top:</b>	Made of AISI 304 stainless steel with a thickness of 20/10 mm
<b>Knobs:</b>	Made of aluminum with IPX5 water protection
<b>Handles:</b>	The brushed aluminum handles allow for a secure and sturdy grip with a ergonomic lines
<b>Liquid collection container:</b>	Removable and dishwasher safe
<b>Upright Splash guard:</b>	On three sides
<b>Kit Gas:</b>	natural gas conversion kit 30/50 m/bar (tested with natural gas G20)

In order to constantly offer the best possible products we reserve the right to make changes on technical specifications without incurring any obligation for equipment previously or subsequently sold.

Technical draw

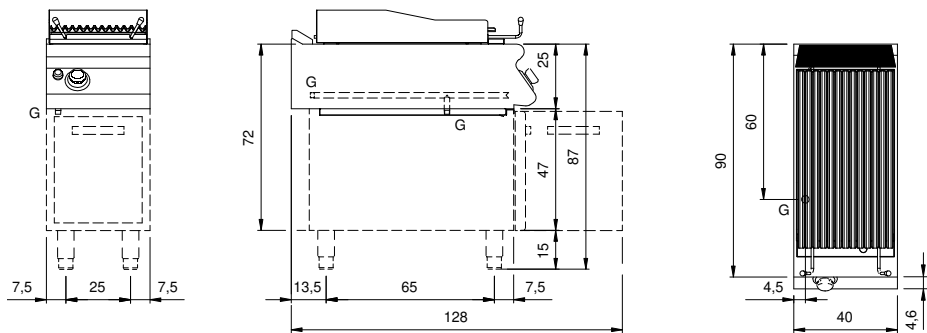

G: Gas connection 1/2"