

Client _____ Quantity _____
 Project _____ Position _____



ROC 900

Electric bain marie, top

Model: R90/40BME/T

Cod: MP01254124000

Technical data

Modularity:	Top
Dimension (mm):	400x900x280
Total electric power (kW):	2,2
Nr. Wells:	1
Well litres 1:	25
Well dimensions 1 (mm):	351x685x155
Electric power (V):	220-240
Ampere (A):	10
Phases:	1
Cable section (mmq):	3G1,5
Frequency (Hz):	50-60
Drain size:	1"
Net volume (m3):	0,101
Packing dimensions (mm):	480x1026x475
Gross weight (Kg):	38,1
Gross volume (m3):	0,234

Features

Working top:	Made of AISI 304 stainless steel with a thickness of 20/10 mm
Knobs:	Made of aluminum with IPX5 water protection
Water inflow:	Manual input

Technical draw

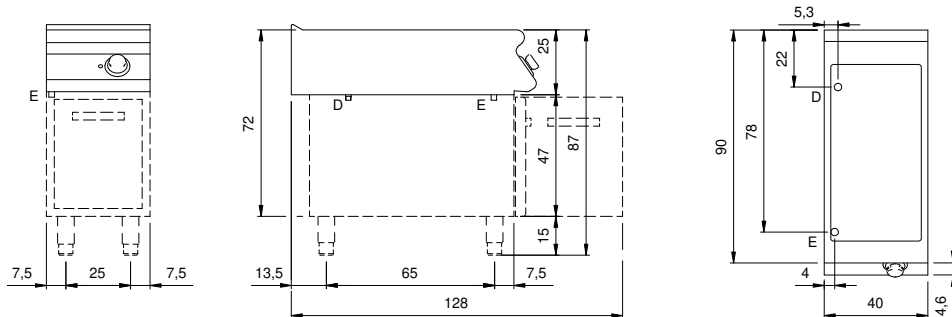

E: Electric power

D: Drain for water