

Client \_\_\_\_\_ Quantity \_\_\_\_\_  
Project \_\_\_\_\_ Position \_\_\_\_\_

## Technical data

---

Modularity:	Top
Dimension (mm):	800x900x280
Total electric power (kW):	4,4
Nr. Wells:	1
Well litres 1:	52
Well dimensions 1 (mm):	730x685x155
Electric power (V):	380-415
Ampere (A):	10
Phases:	3N
Cable section (mmq):	3G2,5
Frequency (Hz):	50-60
Drain size:	1"
Net volume (m3):	0,202
Packing dimensions (mm):	880x1026x509
Gross weight (Kg):	58,1
Gross volume (m3):	0,460

## ROC 900

Electric bain marie, top

**Model:** R90/80BME/T

**Cod:** MP01254124003

## Features

---

<b>Working top:</b>	Made of AISI 304 stainless steel with a thickness of 20/10 mm
<b>Knobs:</b>	Made of aluminum with IPX5 water protection
<b>Water inflow:</b>	Manual input

**Technical draw**

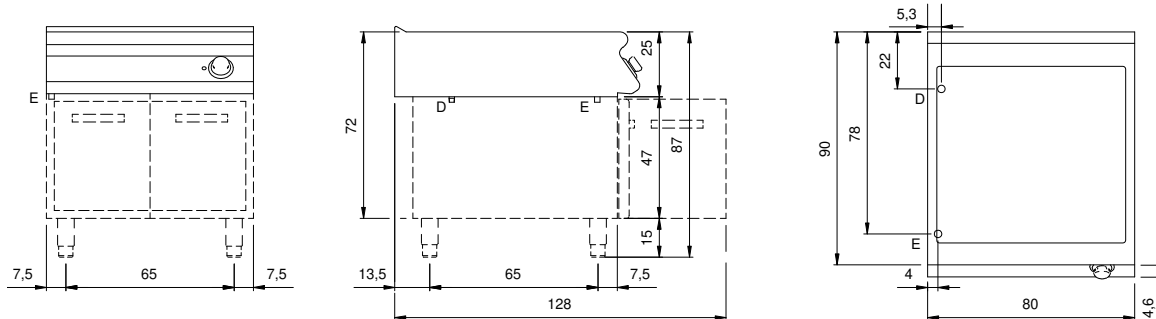

**E:** Electric power

**D:** Drain for water