



Client \_\_\_\_\_ Quantity \_\_\_\_\_  
Project \_\_\_\_\_ Position \_\_\_\_\_

## ROC 900

Manual tilting electric bratt pan, iron well, capacity 80 litres

**Model:** R90/80BRE/80F/S      **Cod:** MP01614124001

### Market:

Extra UE

## Technical data

<b>Modularity:</b>	On closed cabinet
<b>Dimension (mm):</b>	800x900x870
<b>Total electric power (kW):</b>	15
<b>Cooking zone dimensions 1 (LxD mm):</b>	fondo vasca 680x567
<b>Nr. Wells:</b>	1
<b>Well litres 1:</b>	80
<b>Well dimensions 1 (mm):</b>	680x567x170
<b>Electric power (V):</b>	380-415
<b>Ampere (A):</b>	23
<b>Phases:</b>	3N
<b>Cable section (mmq):</b>	5G4
<b>Frequency (Hz):</b>	50-60
<b>Cold water inflow:</b>	3/4"
<b>Cold water pressure (bar):</b>	Pressione Max 5 bar
<b>Net volume (m3):</b>	0,626
<b>Packing dimensions (mm):</b>	880x1026x1109
<b>Gross weight (Kg):</b>	173
<b>Gross volume (m3):</b>	1,001

## Features

<b>Working top:</b>	Made of AISI 304 stainless steel with a thickness of 20/10 mm
<b>Material of plate:</b>	Iron
<b>Plate finish:</b>	Smooth
<b>Tipologia ribaltamento:</b>	Manual input
<b>Knobs:</b>	Made of aluminum with IPX5 water protection
<b>Water inflow:</b>	With solenoid valve

**Technical draw**

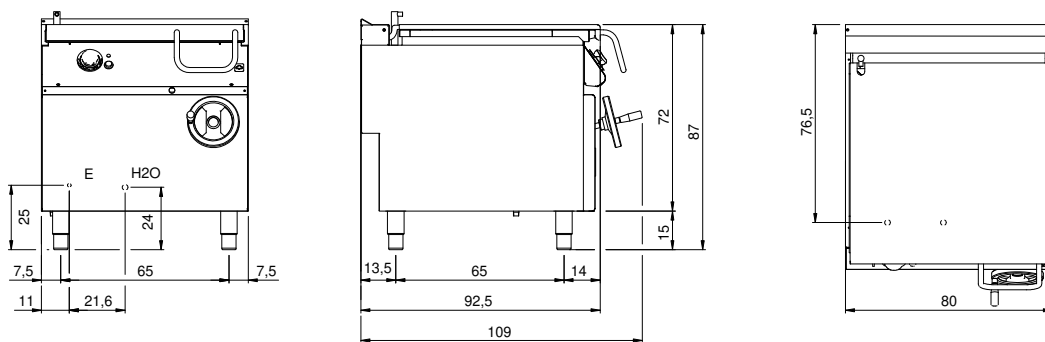

**E:** Electric power

**H2O:** Water inflow 3/4"