

Client _____ Quantity _____
 Project _____ Position _____



ROC 900

Gas bain marie, on open cabinet

Model: R90/40BMG/A

Cod: MP01254114001

Technical data

Modularity:	On open cabinet
Dimension (mm):	400x900x870
Total gas power (Kcal/h):	2580
Total gas power (kW):	3
Nr. Wells:	1
Well litres 1:	25
Well dimensions 1 (mm):	351x685x155
Gas connection:	1/2"
Drain size:	1"
Net volume (m3):	0,313
Packing dimensions (mm):	480x1026x1075
Gross weight (Kg):	50,1
Gross volume (m3):	0,529

Features

Working top:	Made of AISI 304 stainless steel with a thickness of 20/10 mm
Knobs:	Made of aluminum with IPX5 water protection
Flue:	Removable made of cast iron
Water inflow:	Manual input
Kit Gas:	natural gas conversion kit 30/50 m/bar (tested with natural gas G20)

Technical draw

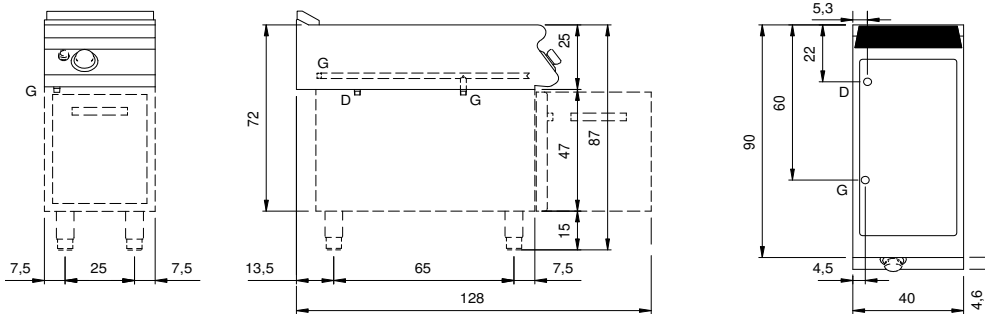

G: Gas connection 1/2"

D: Drain for water