



Client \_\_\_\_\_ Quantity \_\_\_\_\_  
 Project \_\_\_\_\_ Position \_\_\_\_\_

**ROC 900**

Heated chip dump, on open cabinet

**Model:** R90/40SPE/A

**Cod:** MP01334124002

**Technical data**

<b>Modularity:</b>	On open cabinet
<b>Dimension (mm):</b>	400x900x870
<b>Total electric power (kW):</b>	1
<b>Nr. Wells:</b>	1
<b>Well litres 1:</b>	25,5
<b>Well dimensions 1 (mm):</b>	530x325x150
<b>Electric power (V):</b>	220-240
<b>Ampere (A):</b>	5
<b>Phases:</b>	1
<b>Cable section (mmq):</b>	3G1
<b>Frequency (Hz):</b>	50-60
<b>Net volume (m3):</b>	0,313
<b>Packing dimensions (mm):</b>	480x1026x1075
<b>Gross weight (Kg):</b>	45,1
<b>Gross volume (m3):</b>	0,529

**Features**

<b>Working top:</b>	Made of AISI 304 stainless steel with a thickness of 20/10 mm
<b>Knobs:</b>	Made of aluminum with IPX5 water protection
<b>Heating:</b>	Infrared ceramic heating elements

In order to constantly offer the best possible products we reserve the right to make changes on technical specifications without incurring any obligation for equipment previously or subsequently sold.

Technical draw

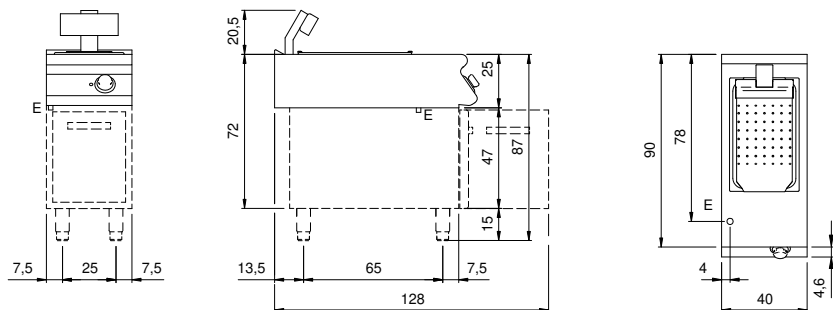

E: Electric power