

Client _____ Quantity _____
 Project _____ Position _____

FUN 700

Gas griddle, smooth mild steel plate, top



Model: F70/40FTG/L/T

Cod: MP01372113002

Market:

Extra UE

Technical data

Modularity:	Top
Dimension (mm):	400x700x300
Total gas power (Kcal/h):	4902
Total gas power (kW):	5,7
Cooking zone dimensions 1 (LxD mm):	396x520
Gas connection:	1/2"
Net volume (m3):	0,084
Packing dimensions (mm):	477x776x612
Gross weight (Kg):	44
Gross volume (m3):	0,227

Features

Working top:	Realizzato in acciaio inox AISI 304 con spessore 10/10 mm
Material of plate:	Iron
Plate finish:	Smooth
Knobs:	Knobs are made from a sturdy heat-resistant polymer blend and are equipped with liquid anti-leakage washer
Plate:	In mild steel
Kit Gas:	natural gas conversion kit 30/50 m/bar (tested with natural gas G20)

Technical draw

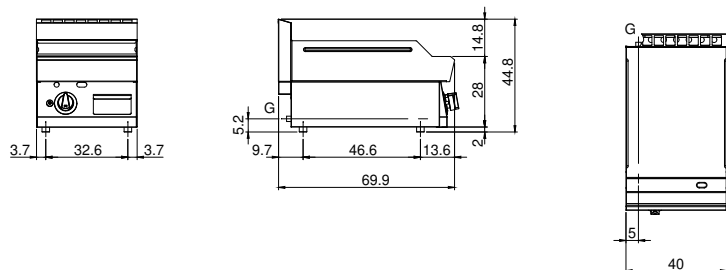

G: Gas connection 1/2"